

LEGO Mindstorms EV3 Dancing Robot Build Instructions

Video Instructions also available on our Youtube Channel:

<https://www.youtube.com/Teachkidsengineering>

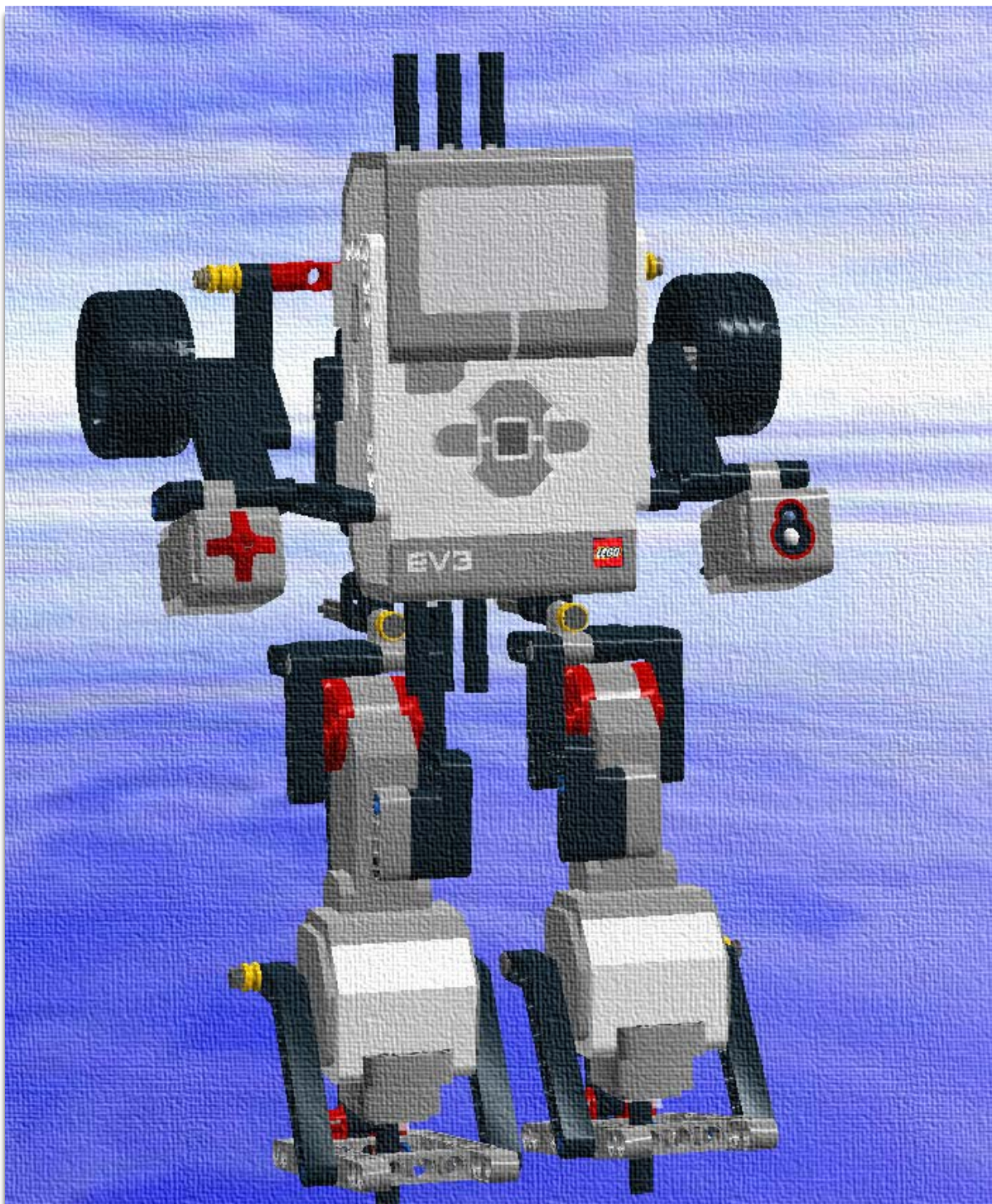

Right Leg



1

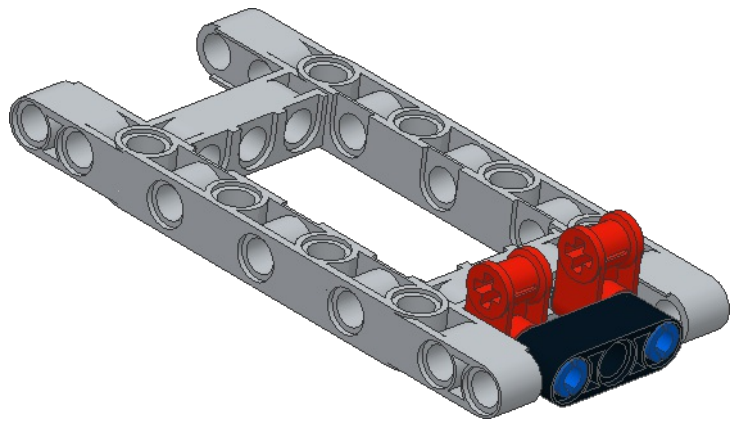
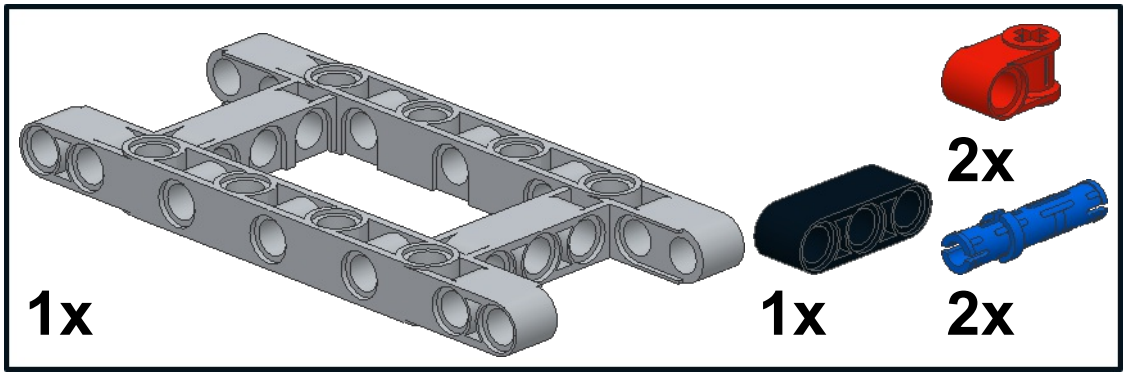

2

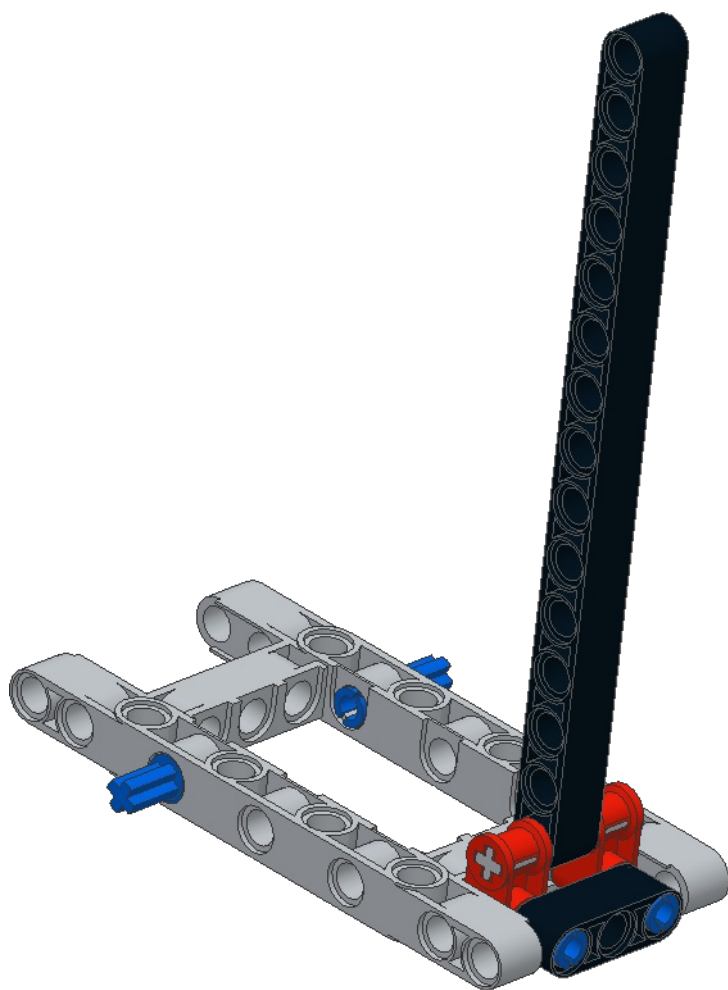
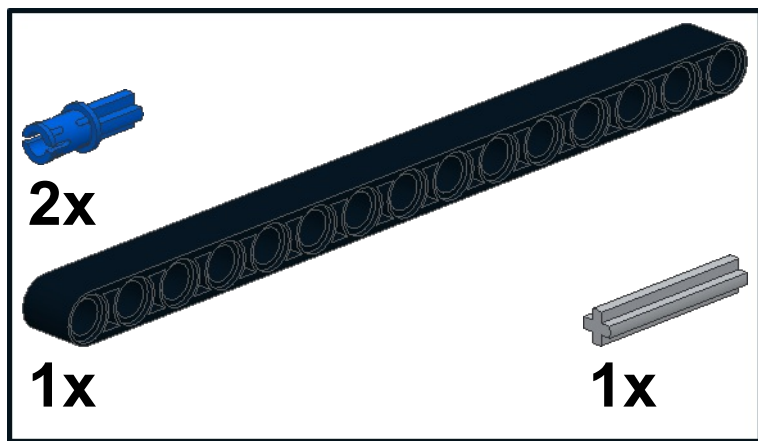

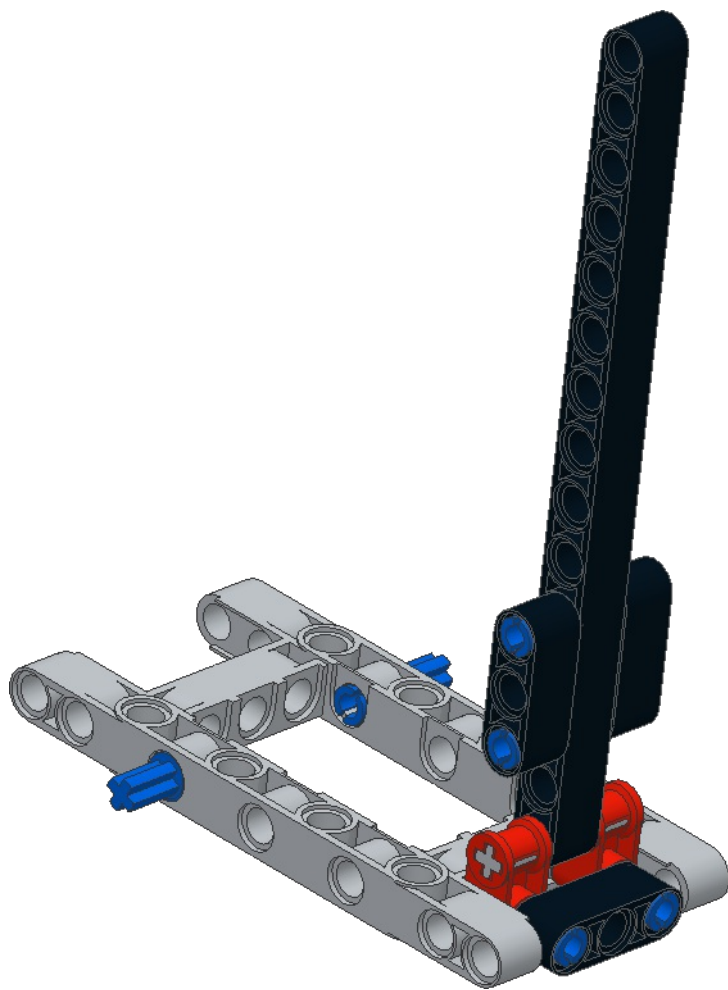
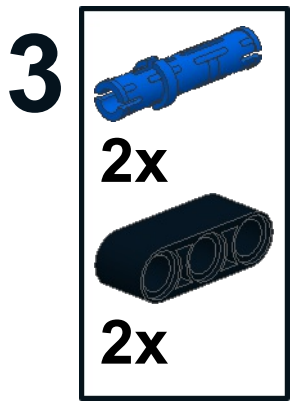

4

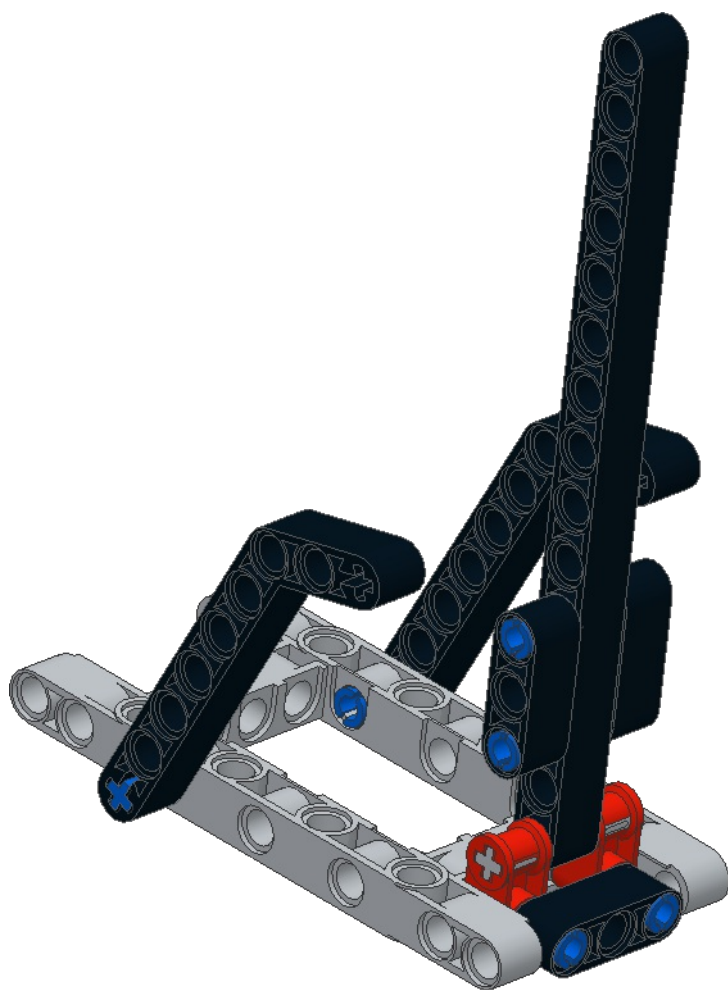

5



1x

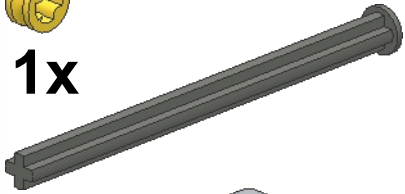

1x

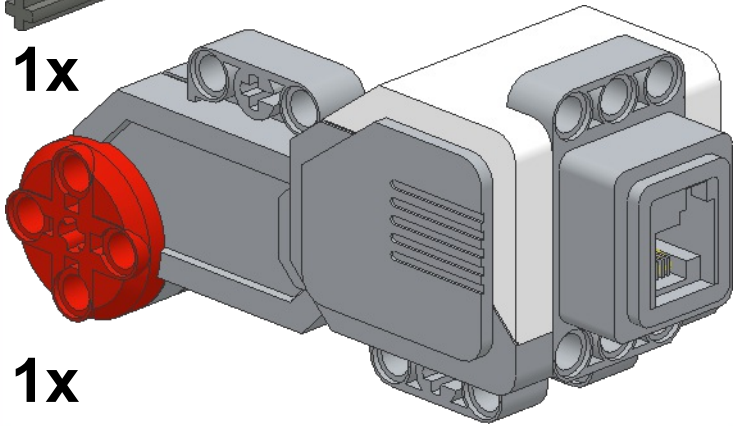

1x

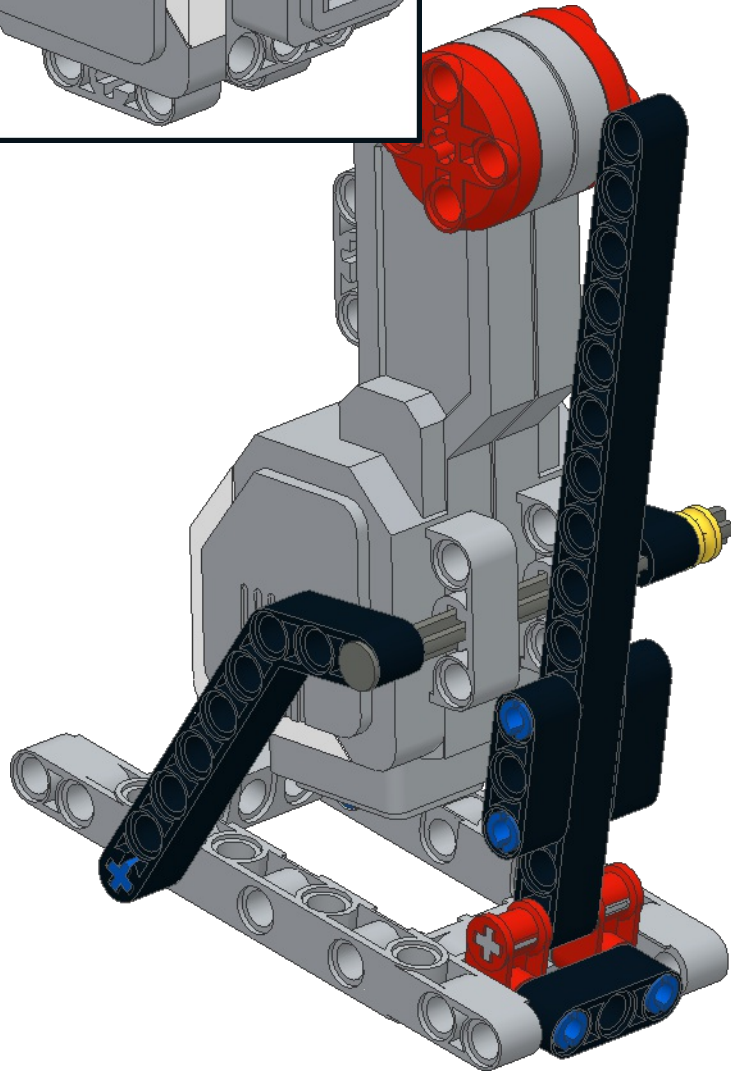

6



1x

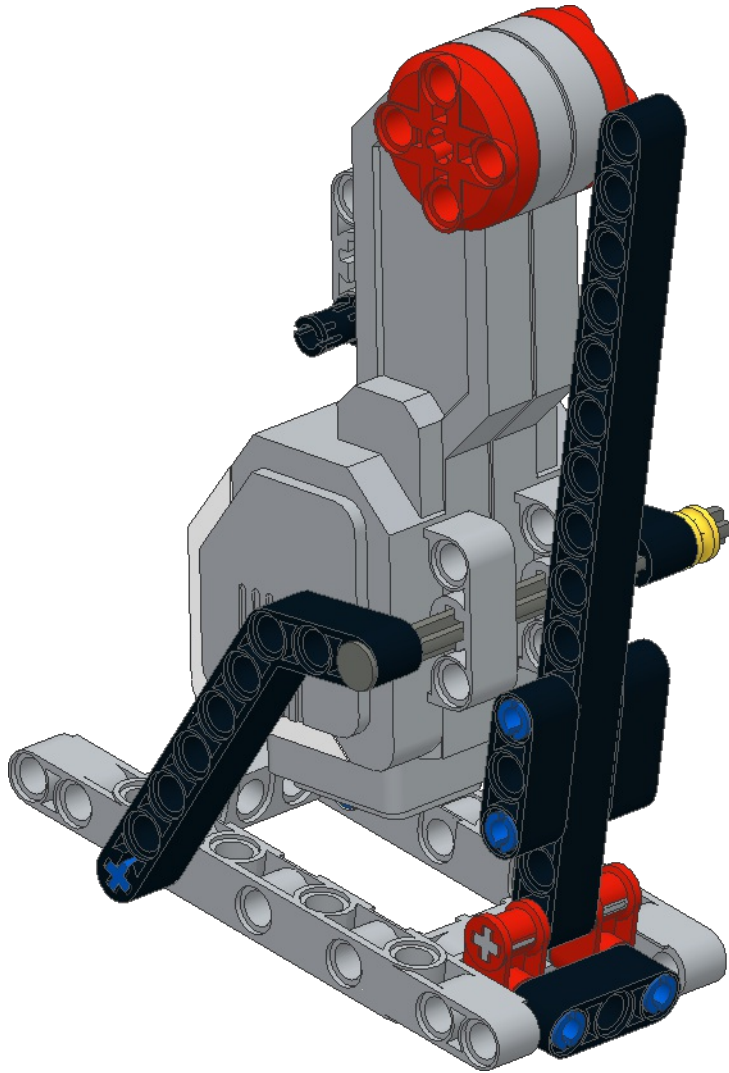

7



1x



1x

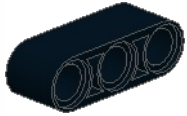

1x

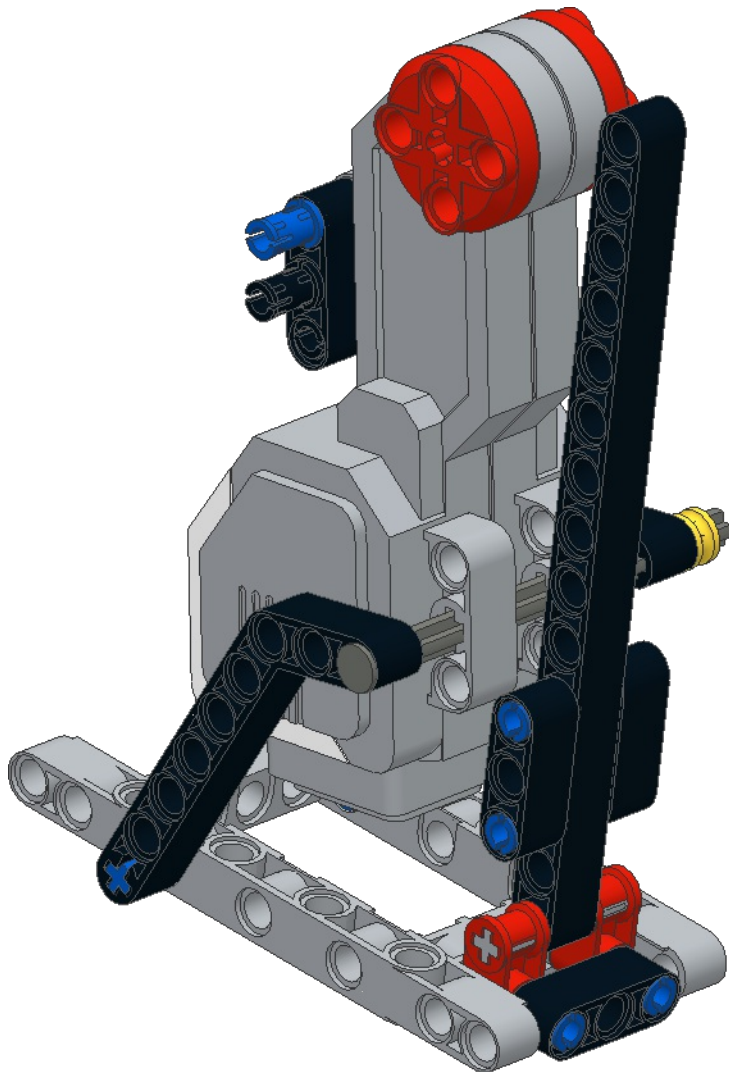

8

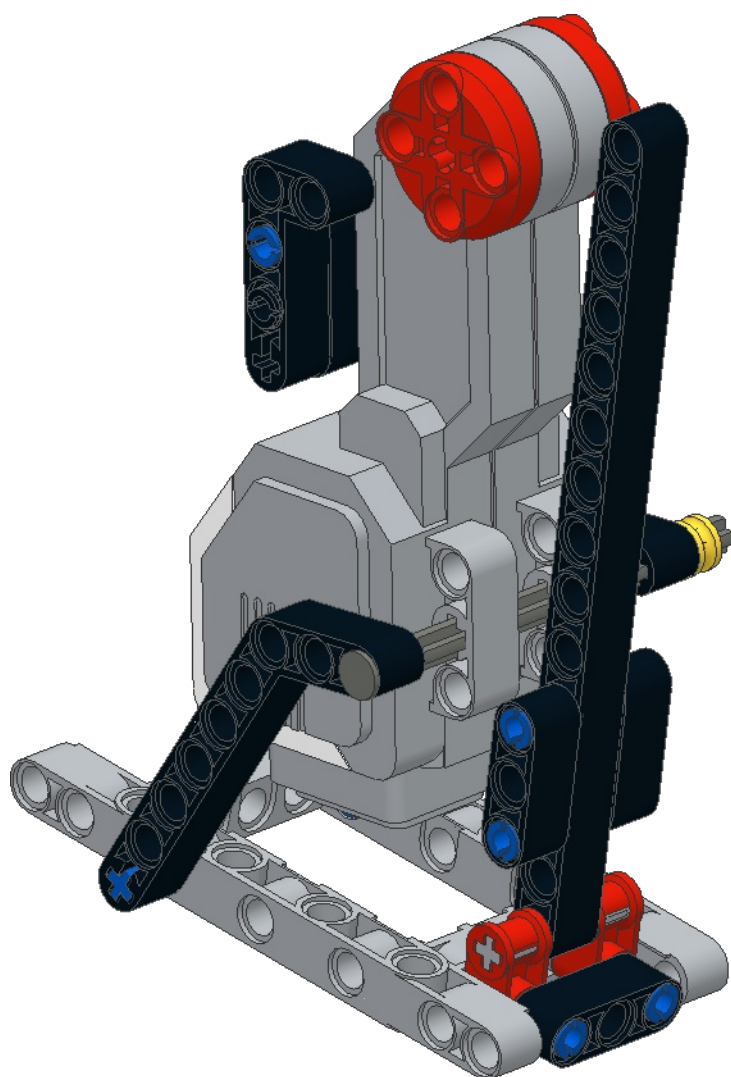
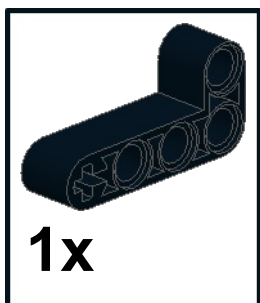

9 
2x

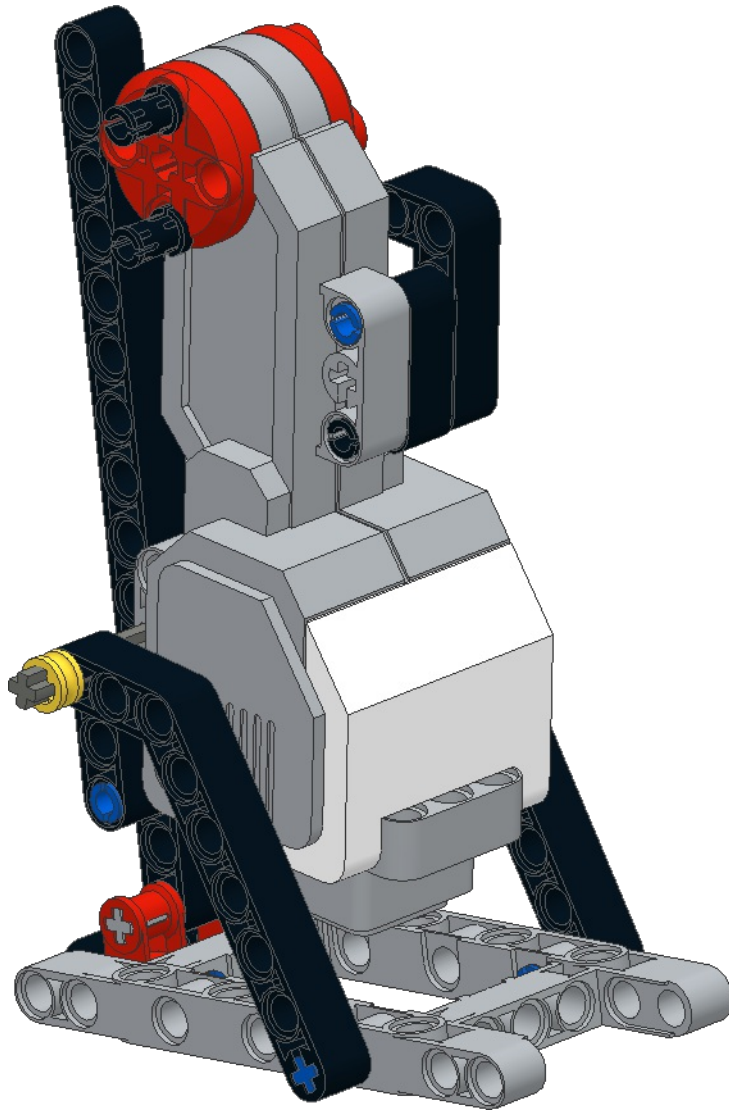

10

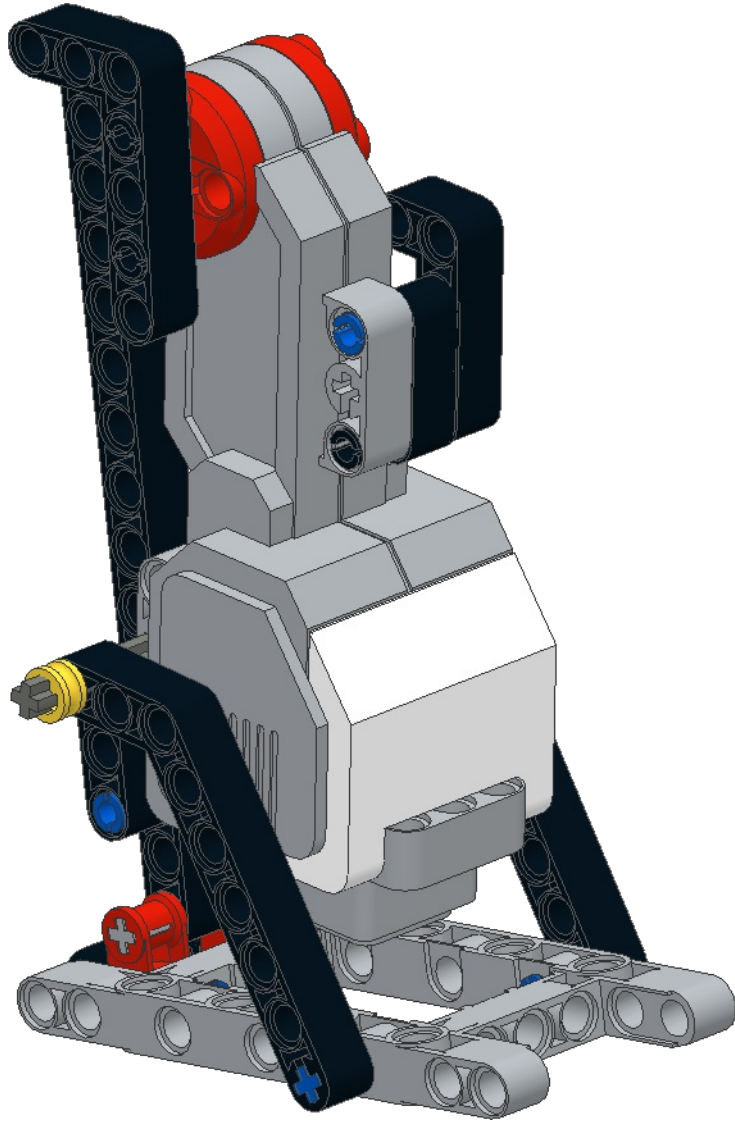
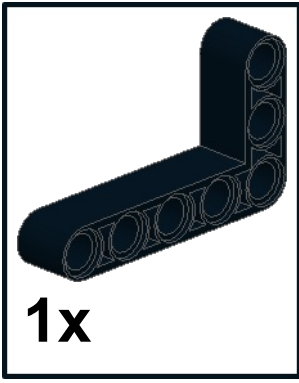

11

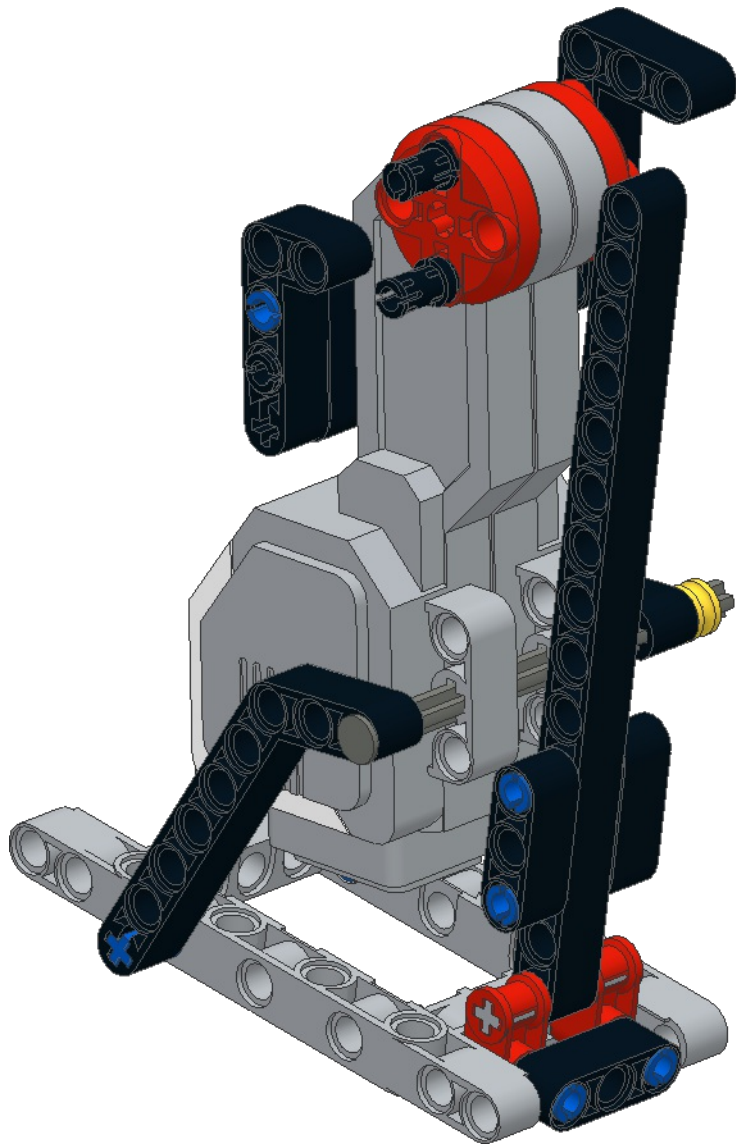

12

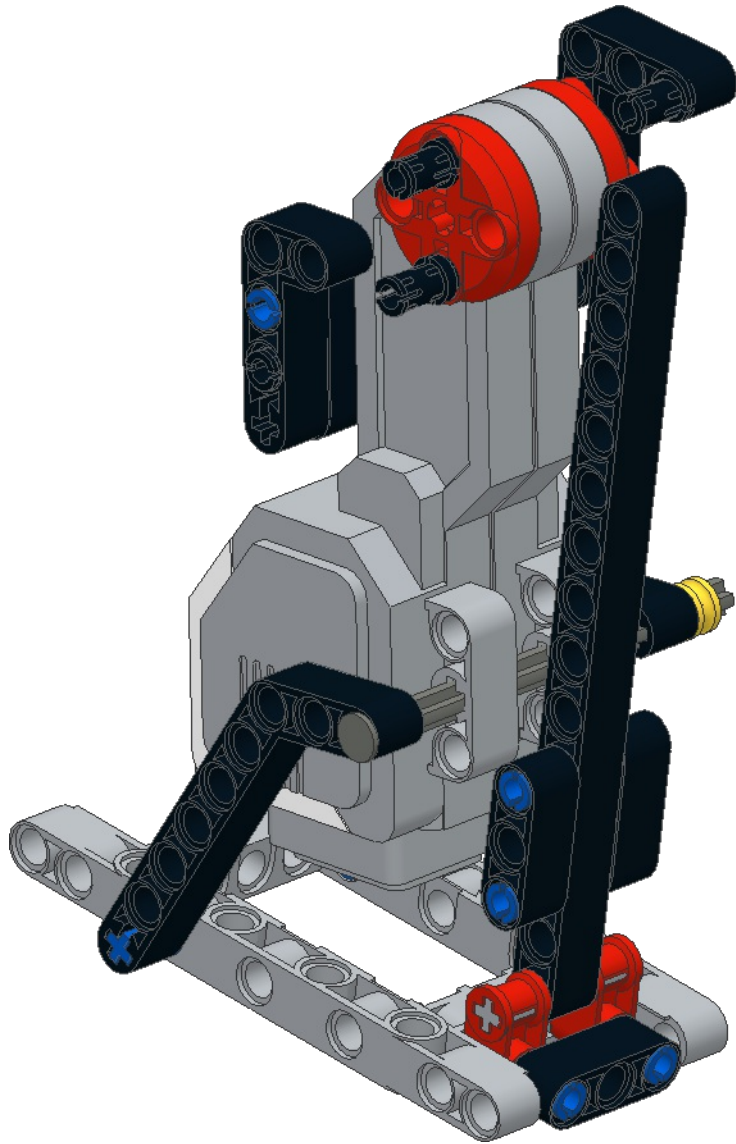
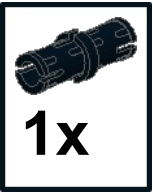

13

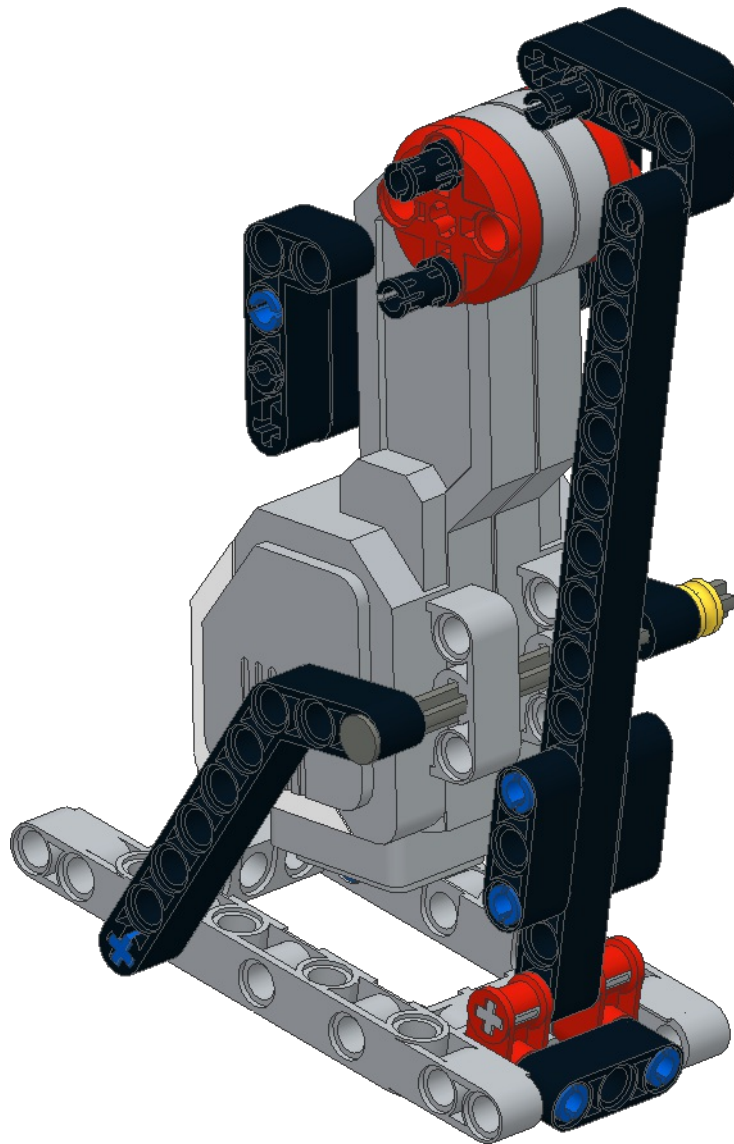
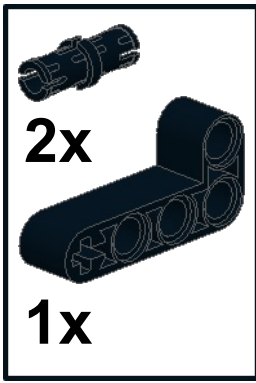

14

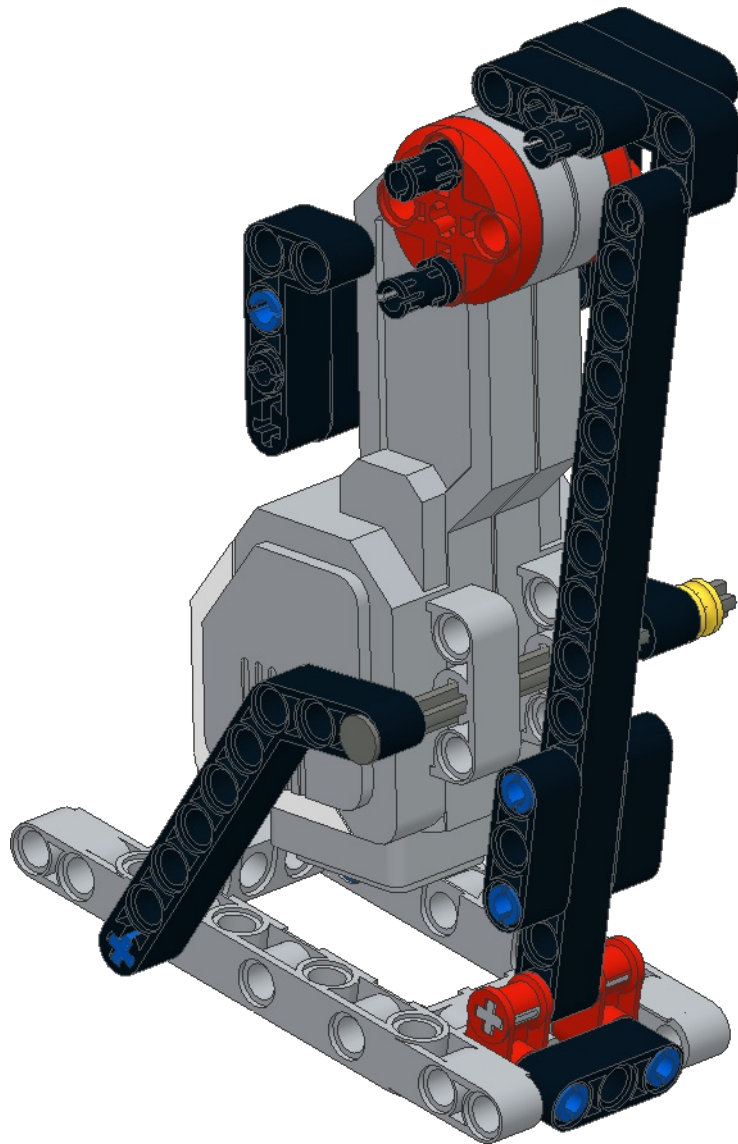
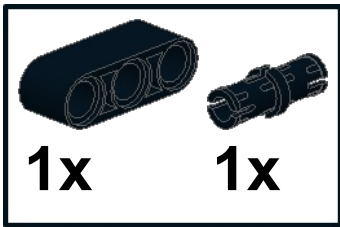

15



1x

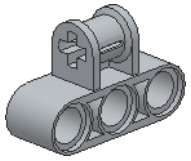

1x

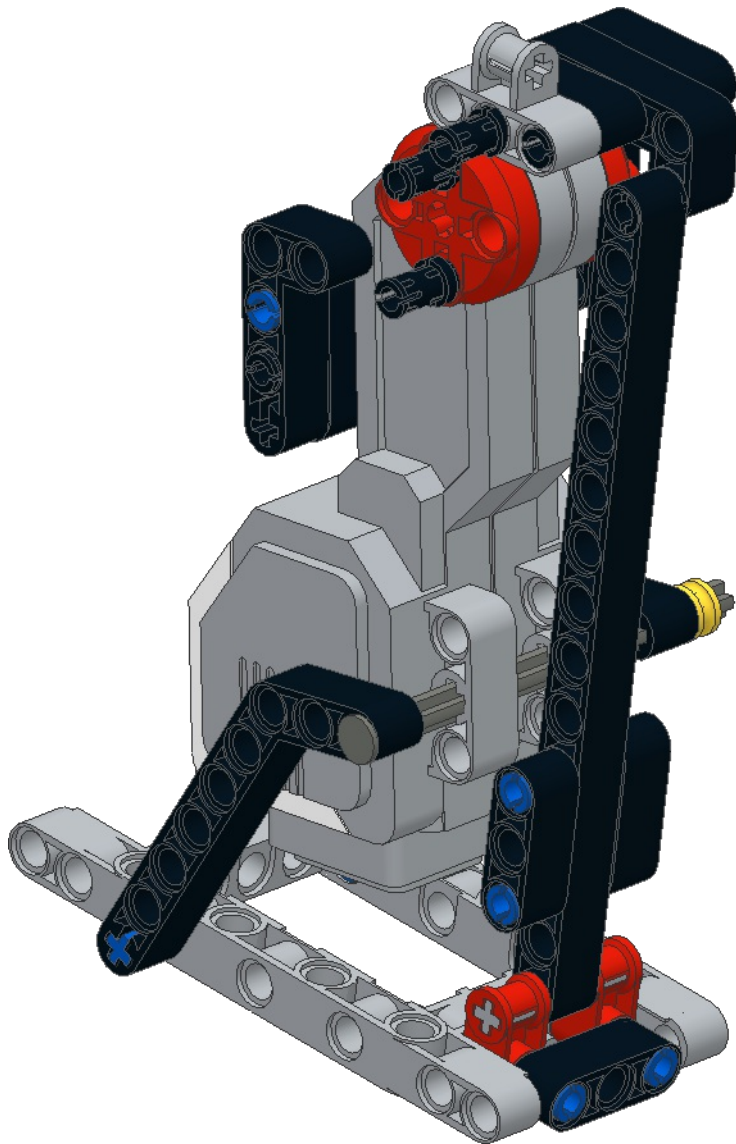

16

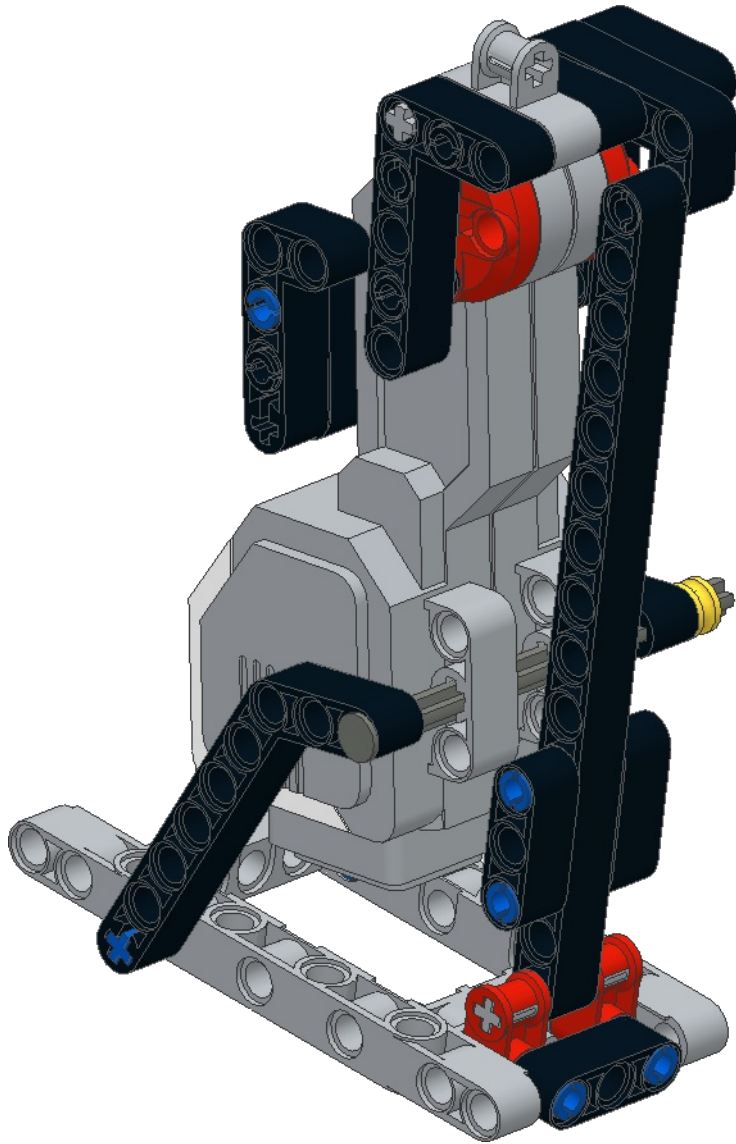
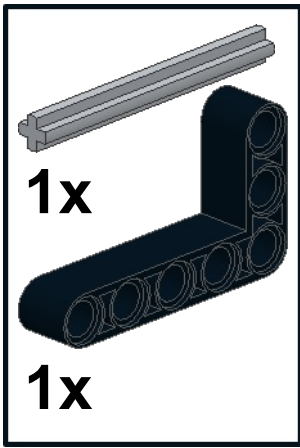

17

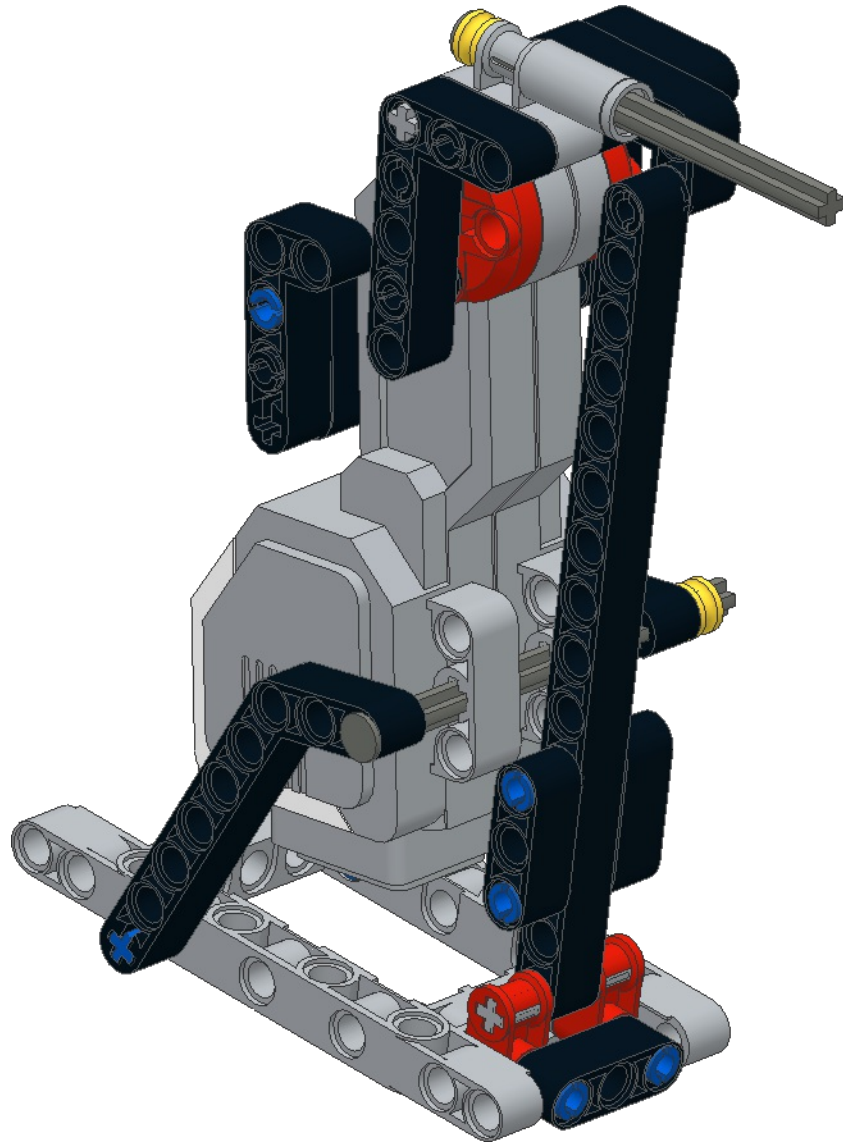
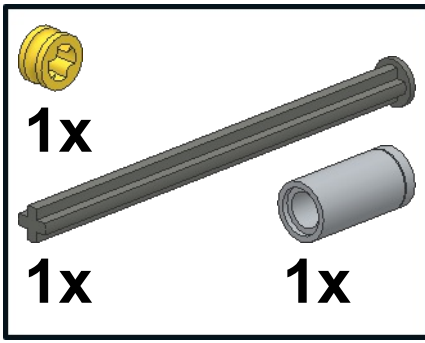

Left Leg

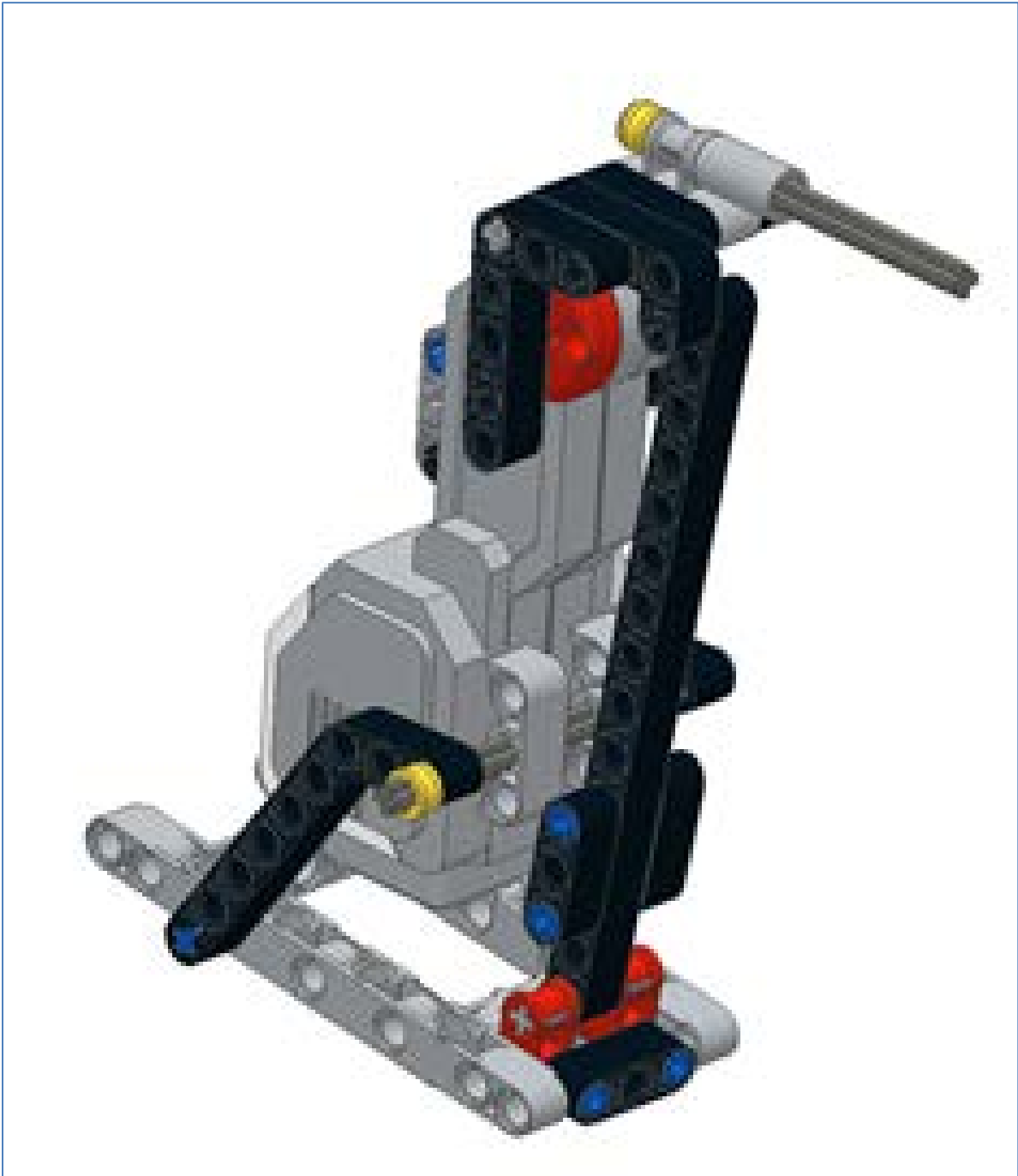

1

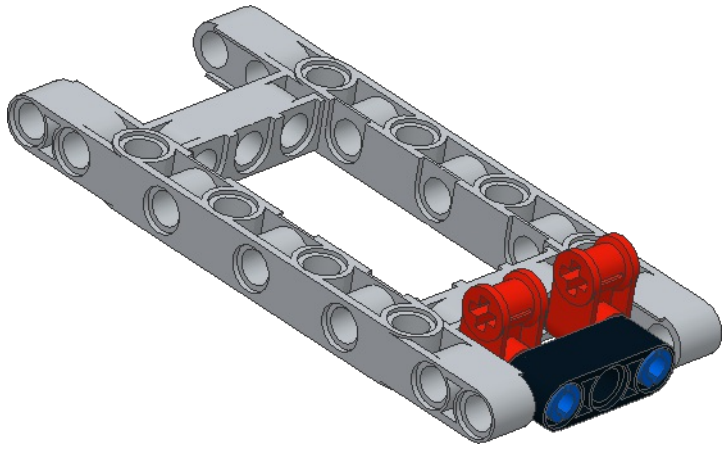
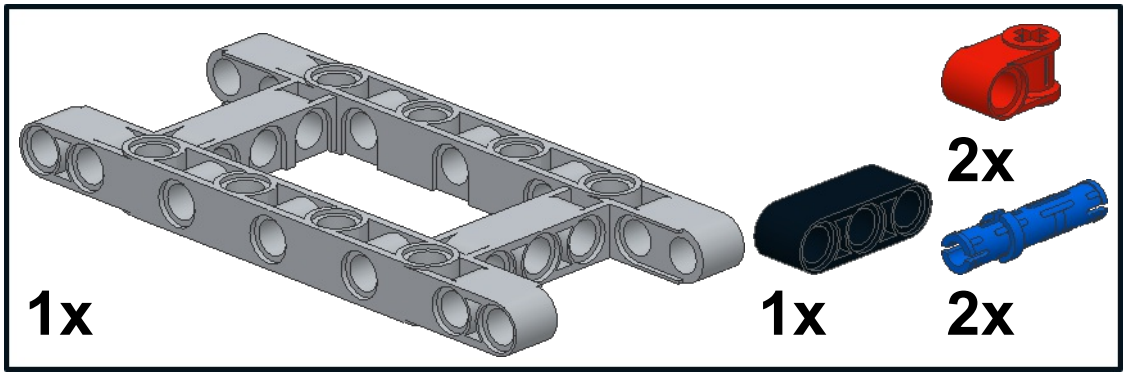

2

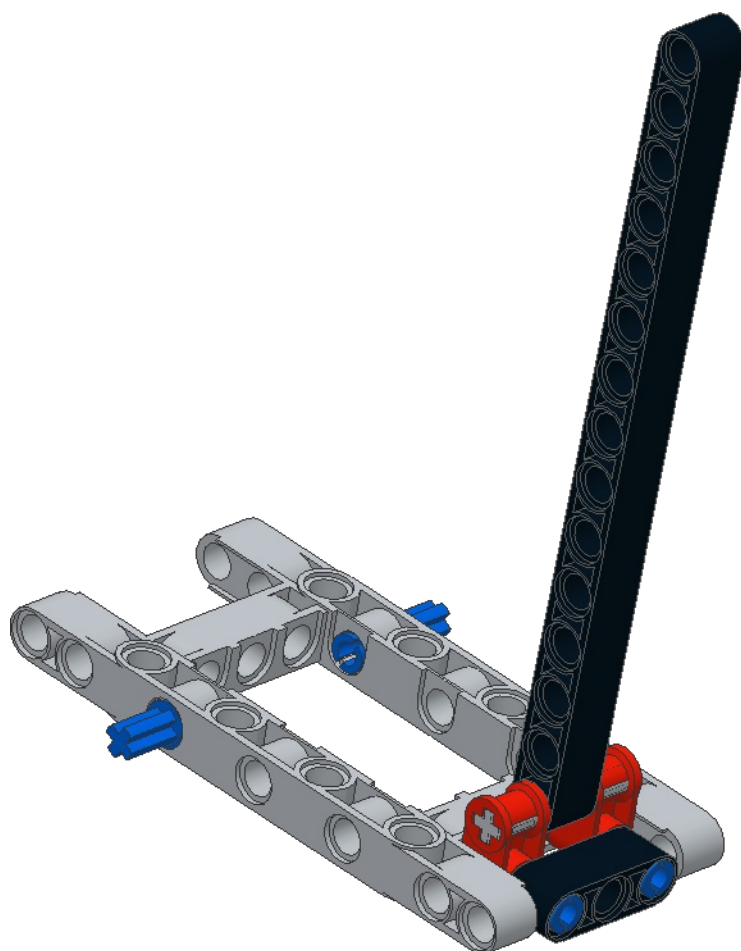
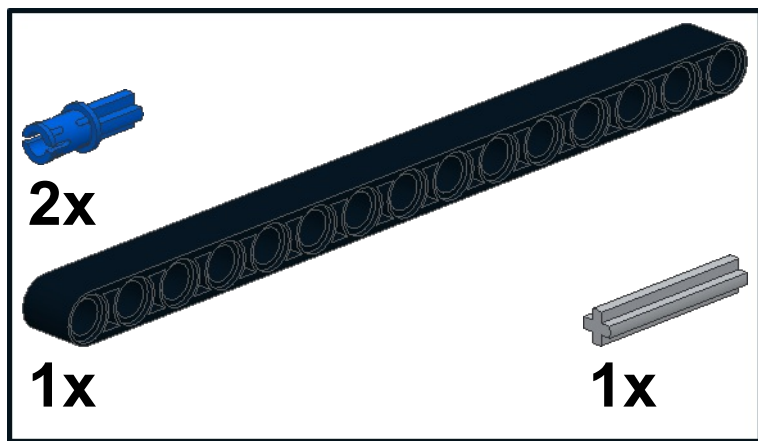

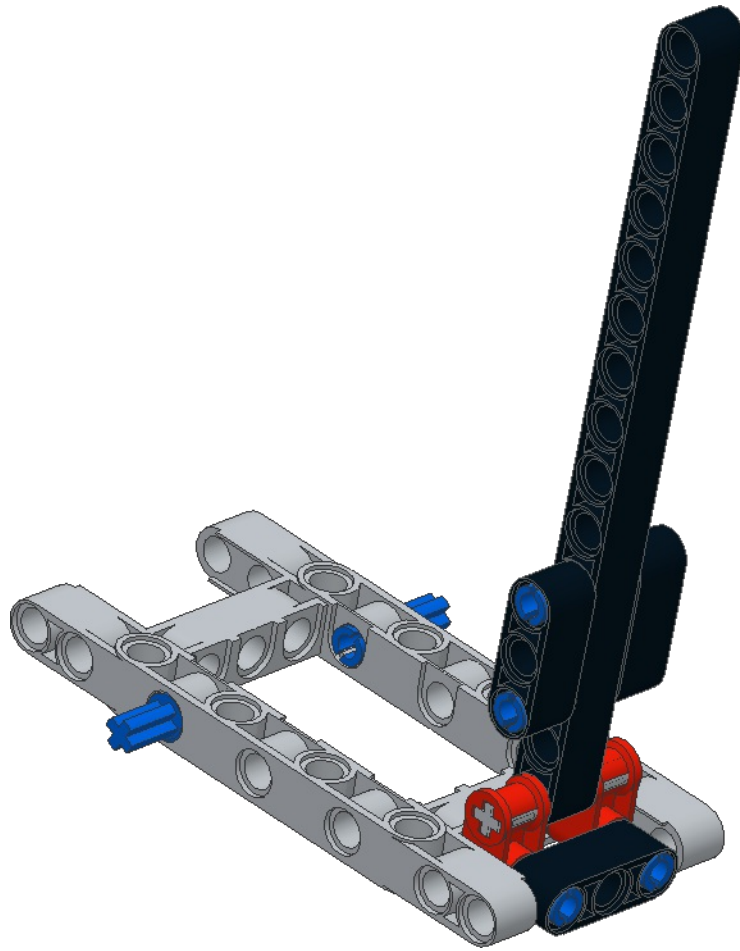
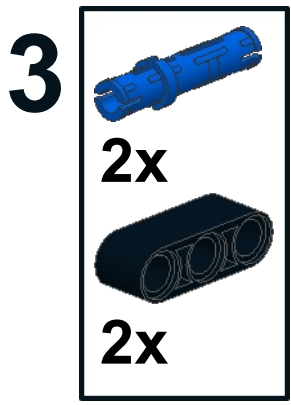

4

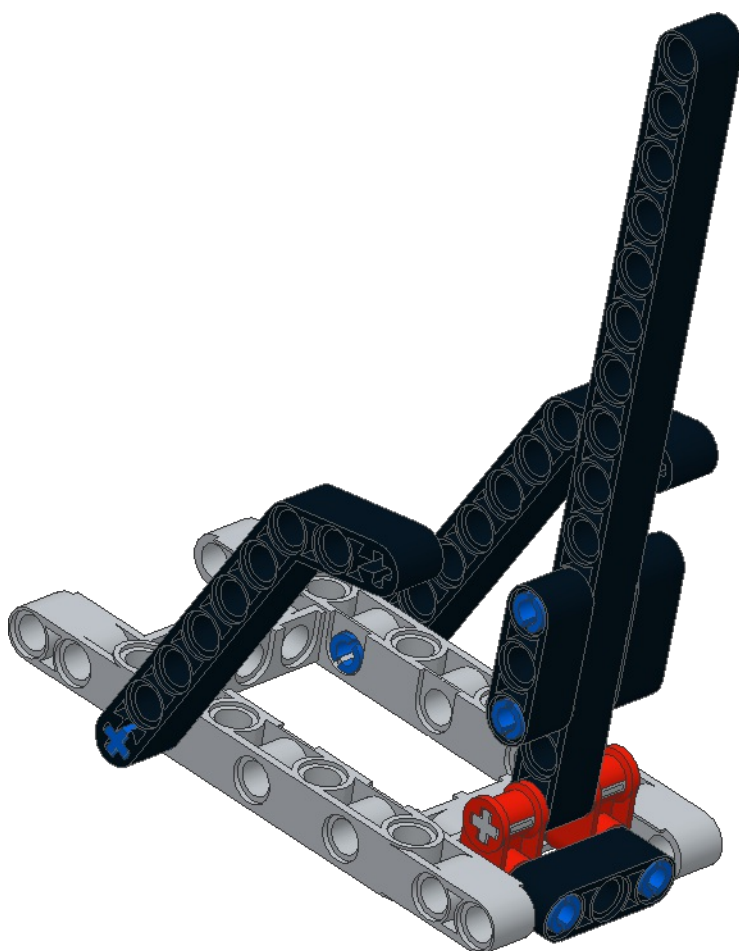

5



1x

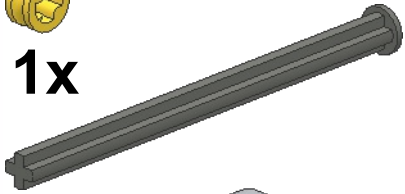

1x

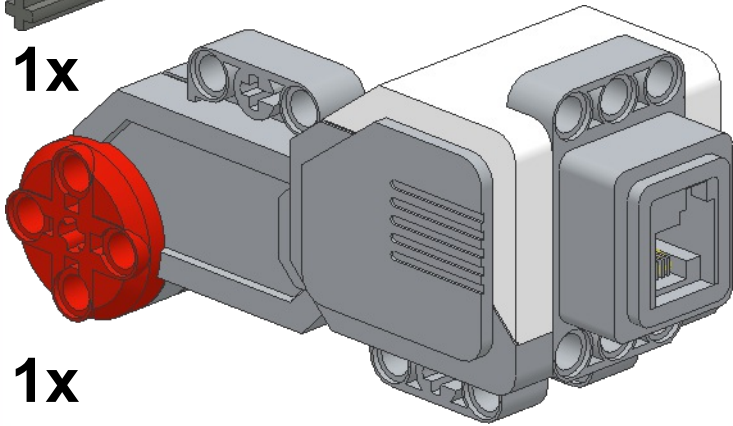

1x

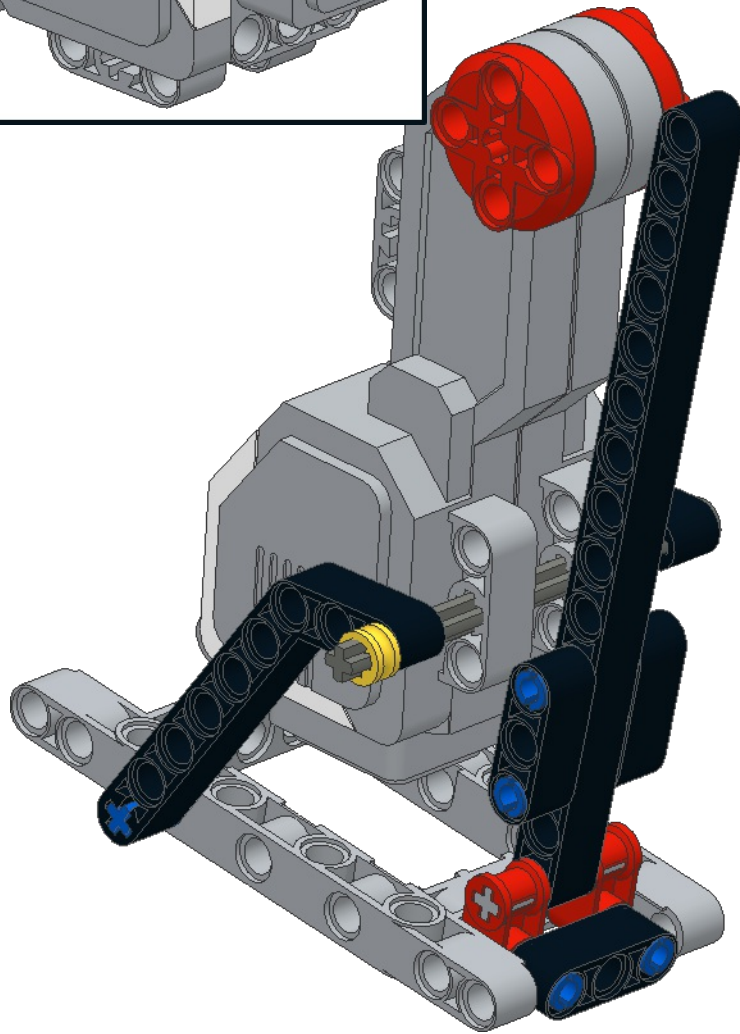

6



1x

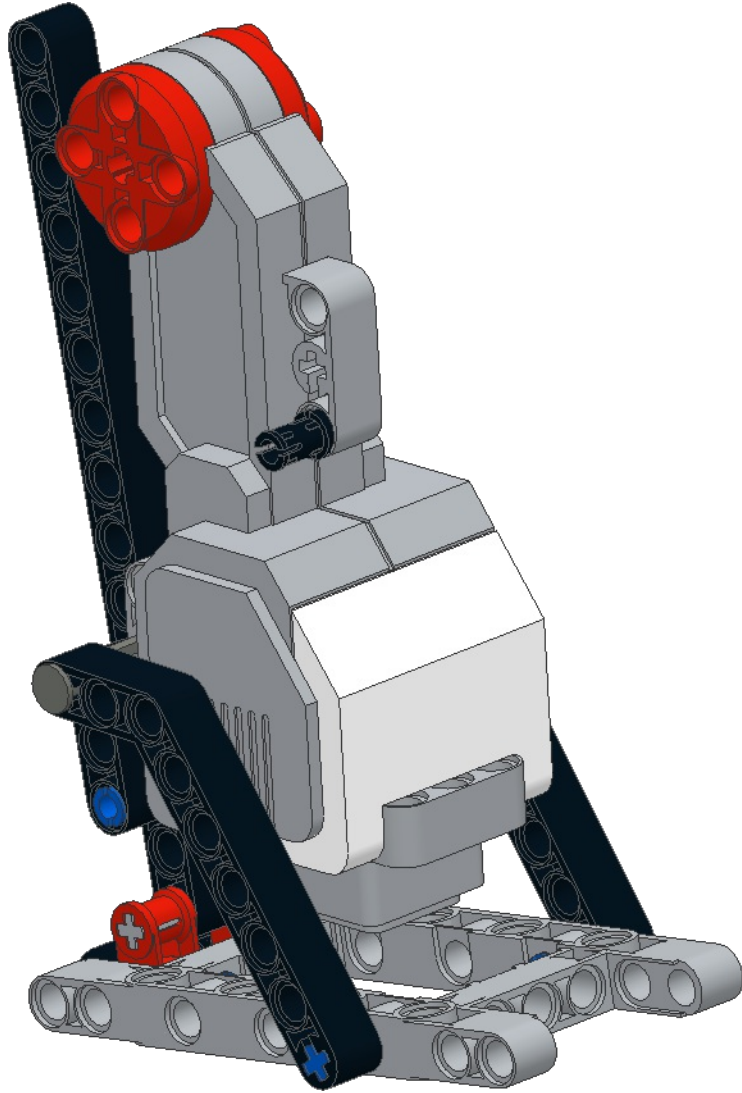

7



1x



1x



1x

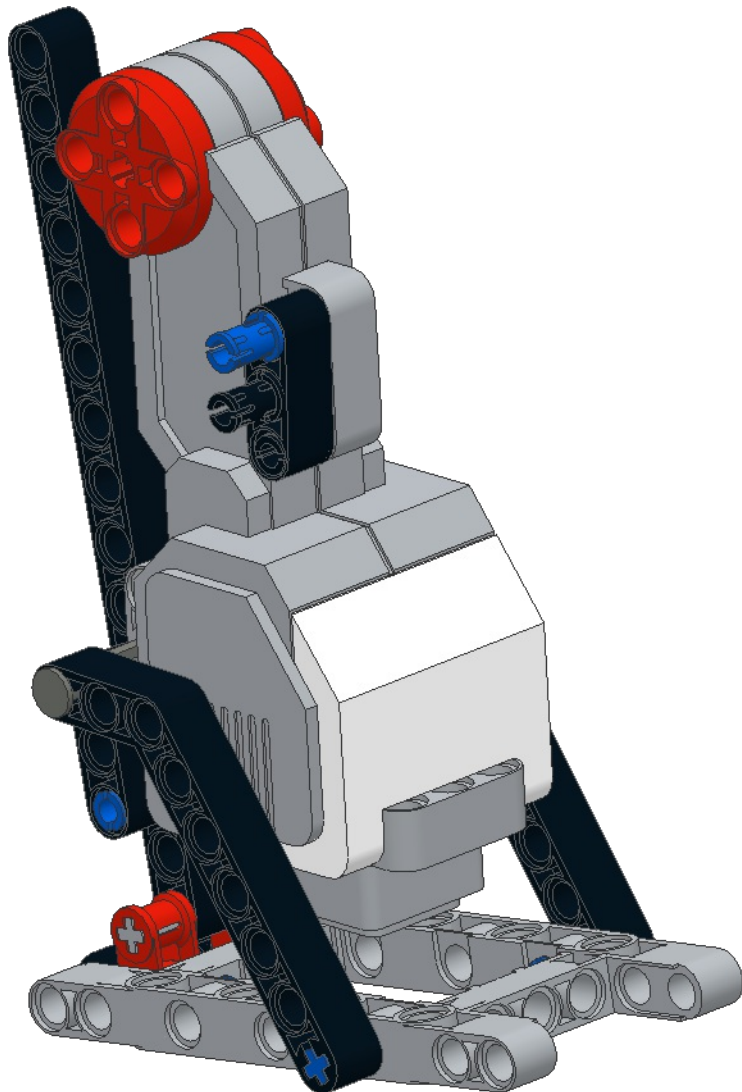

8

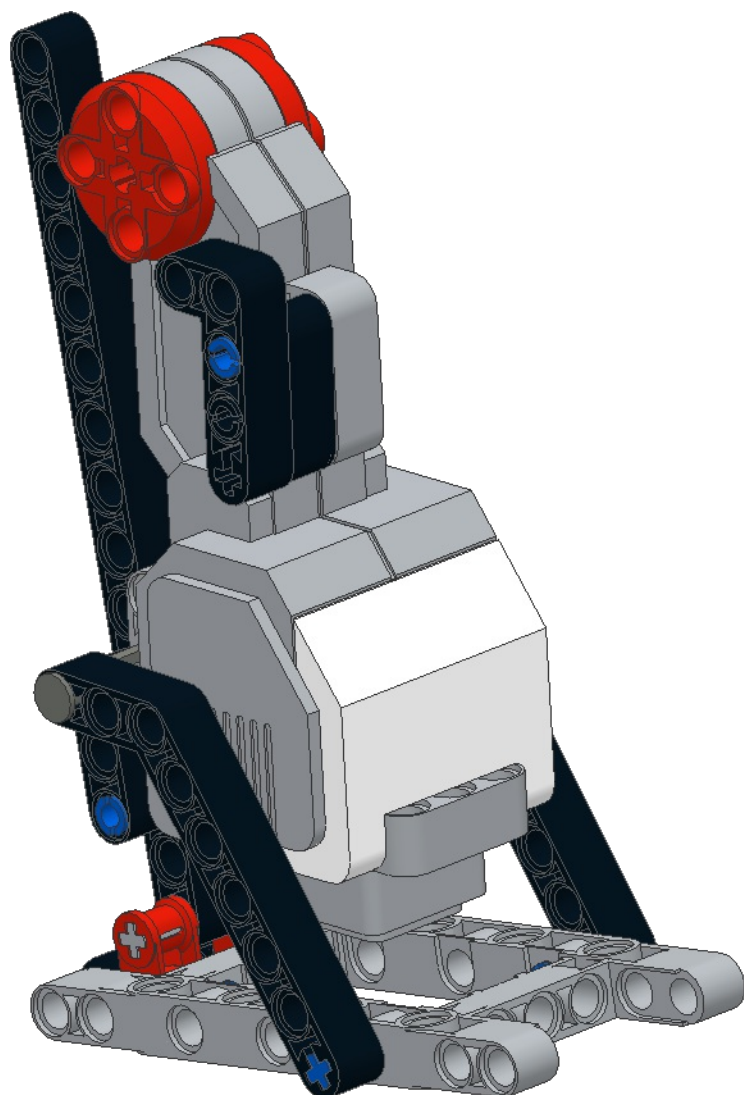
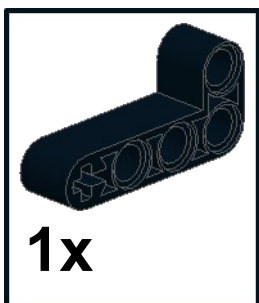

9



2x

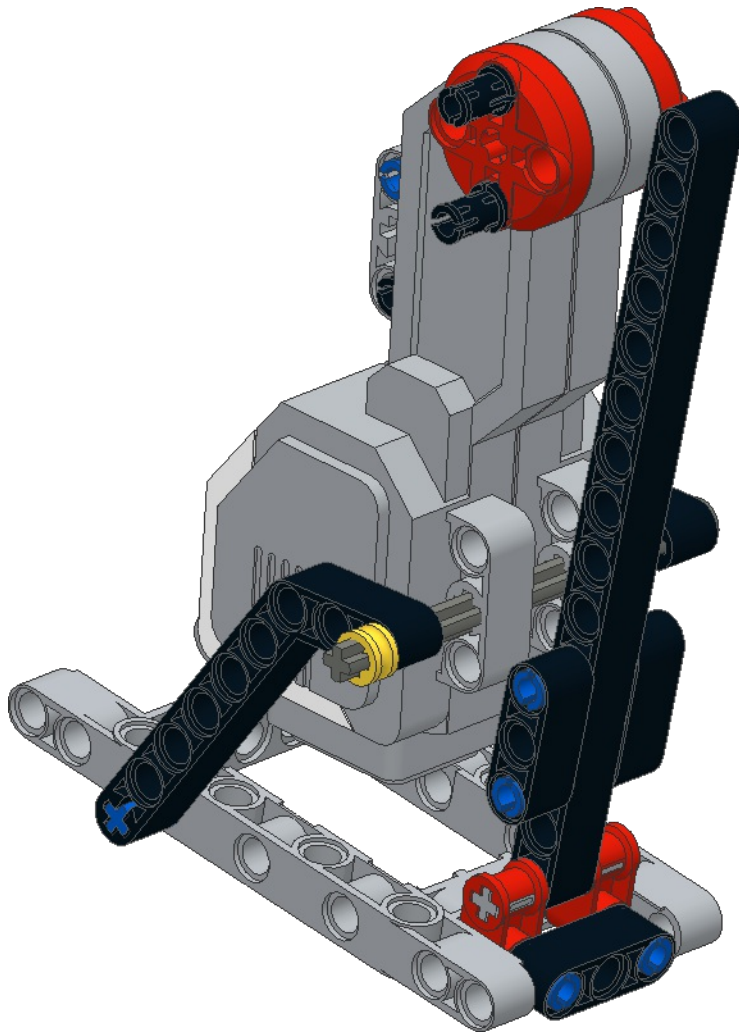

10

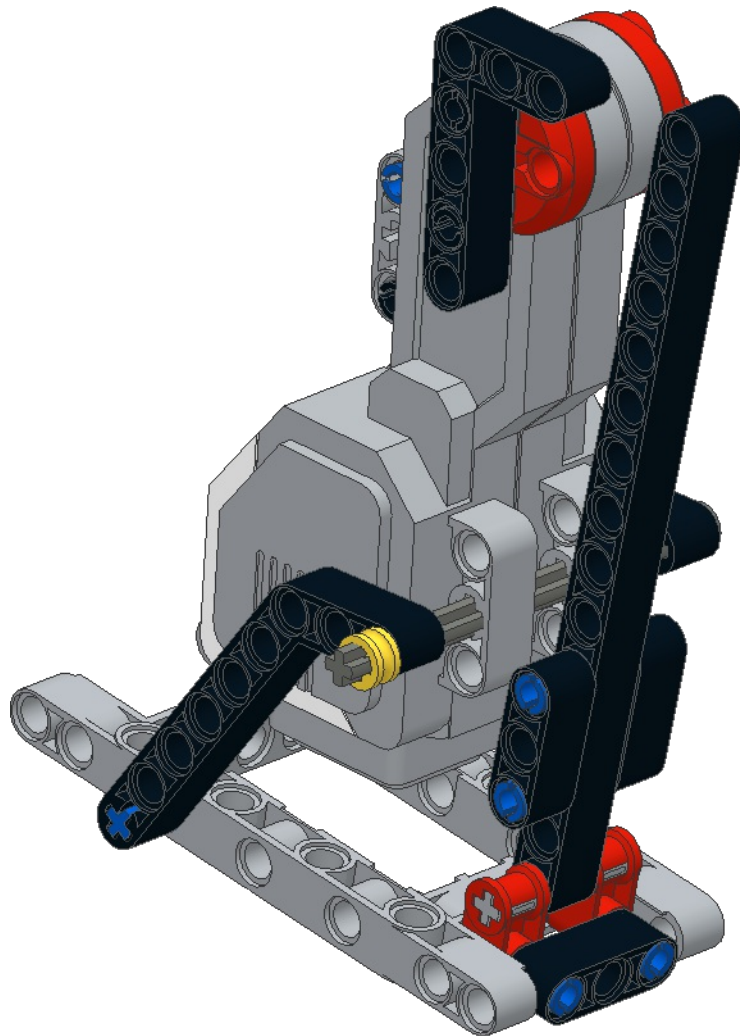
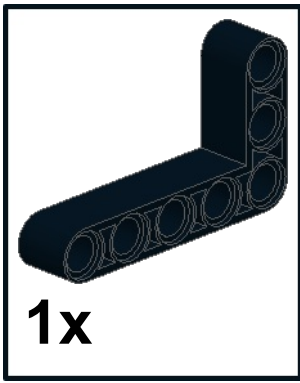

11

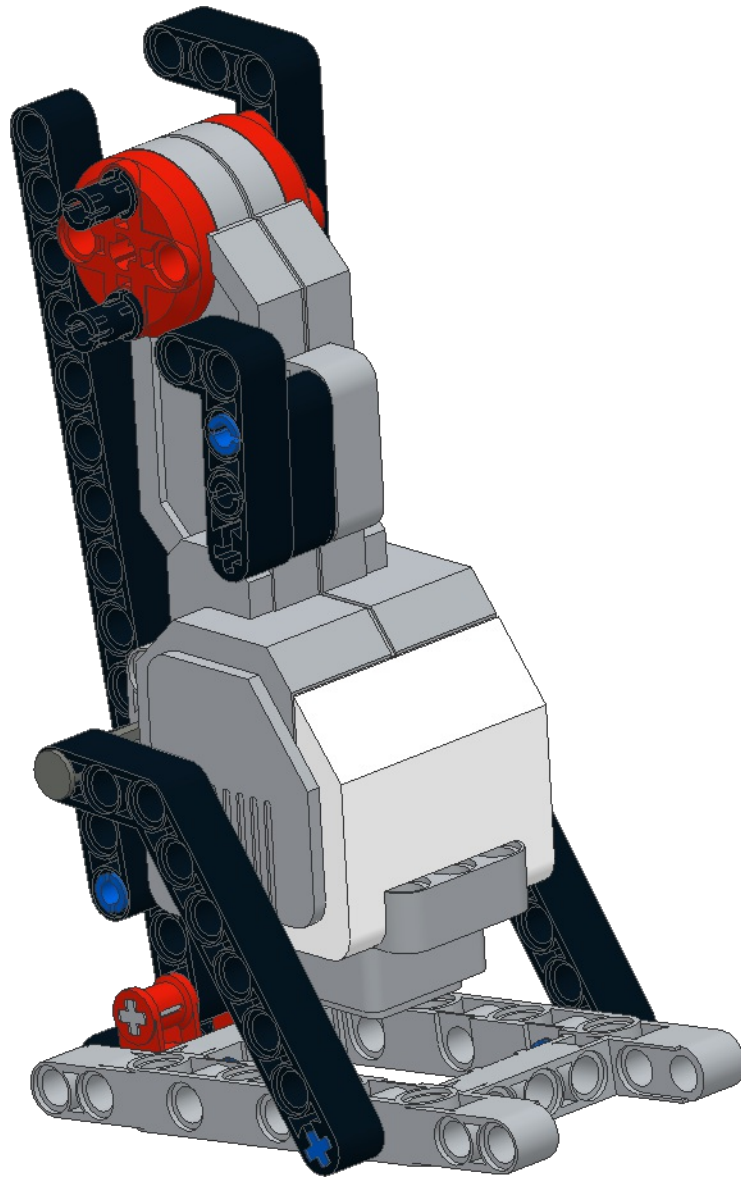

12

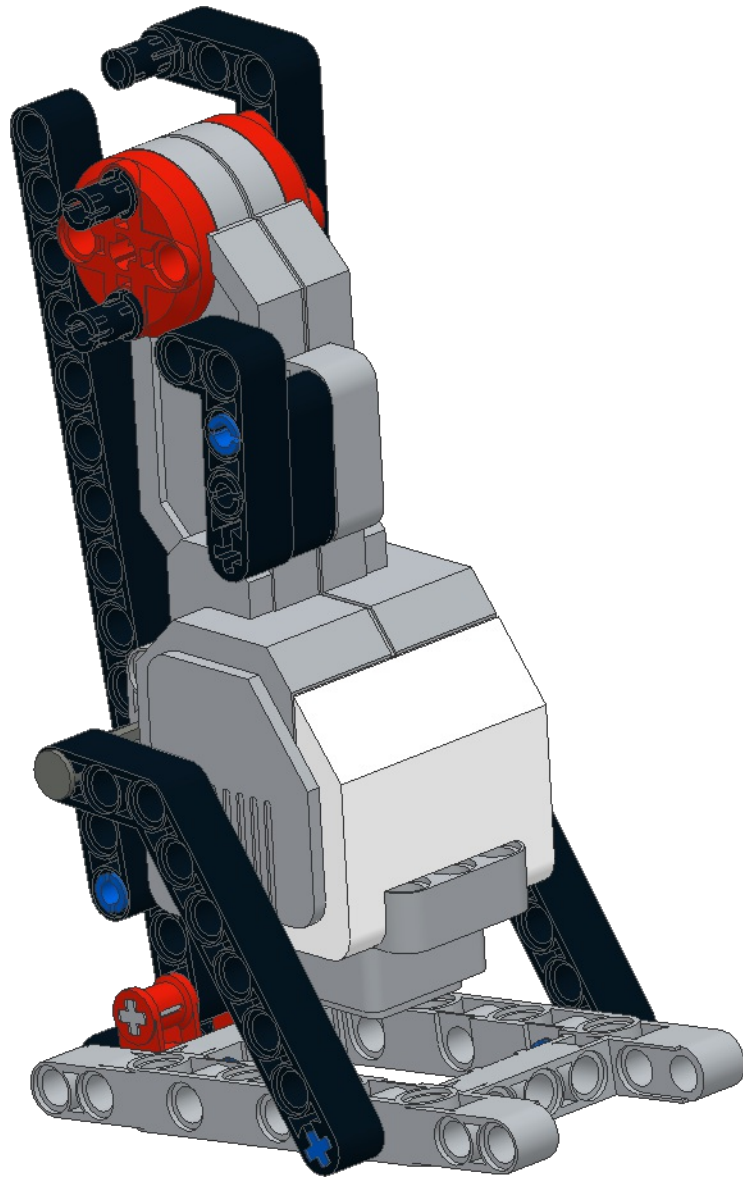
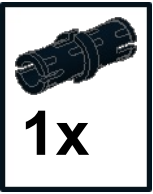

13

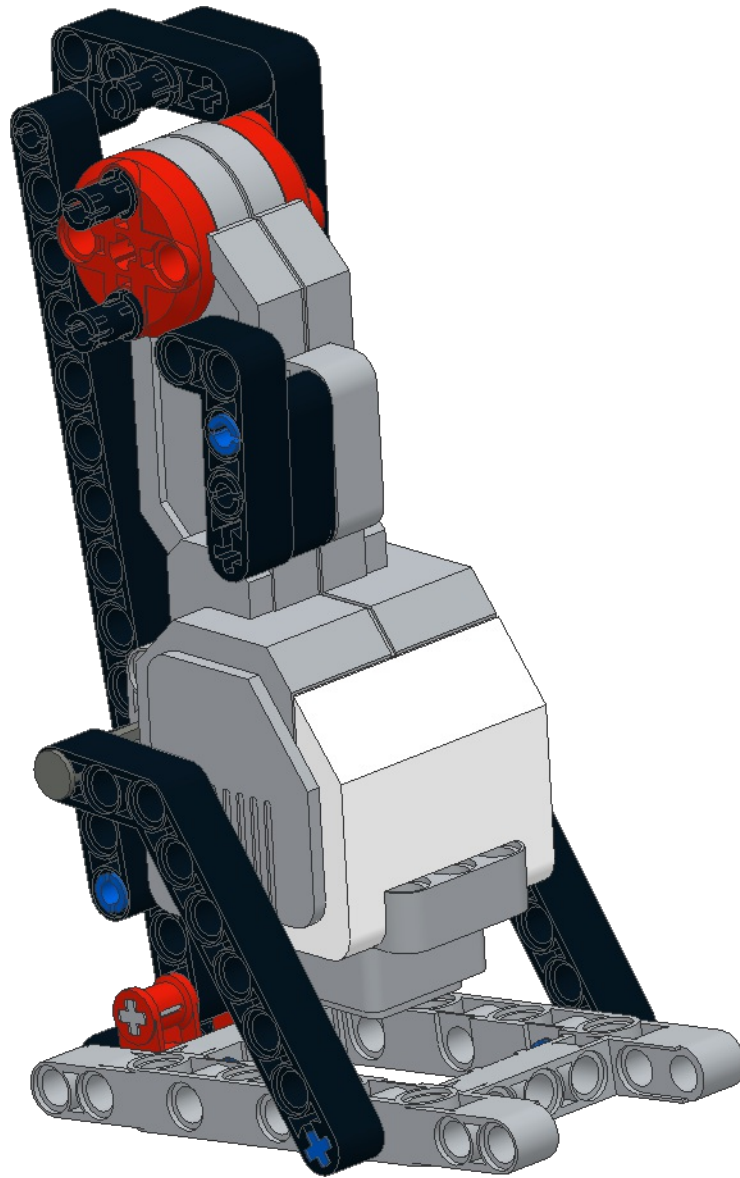
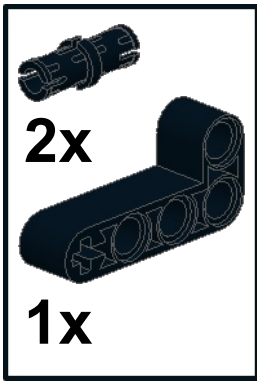

14

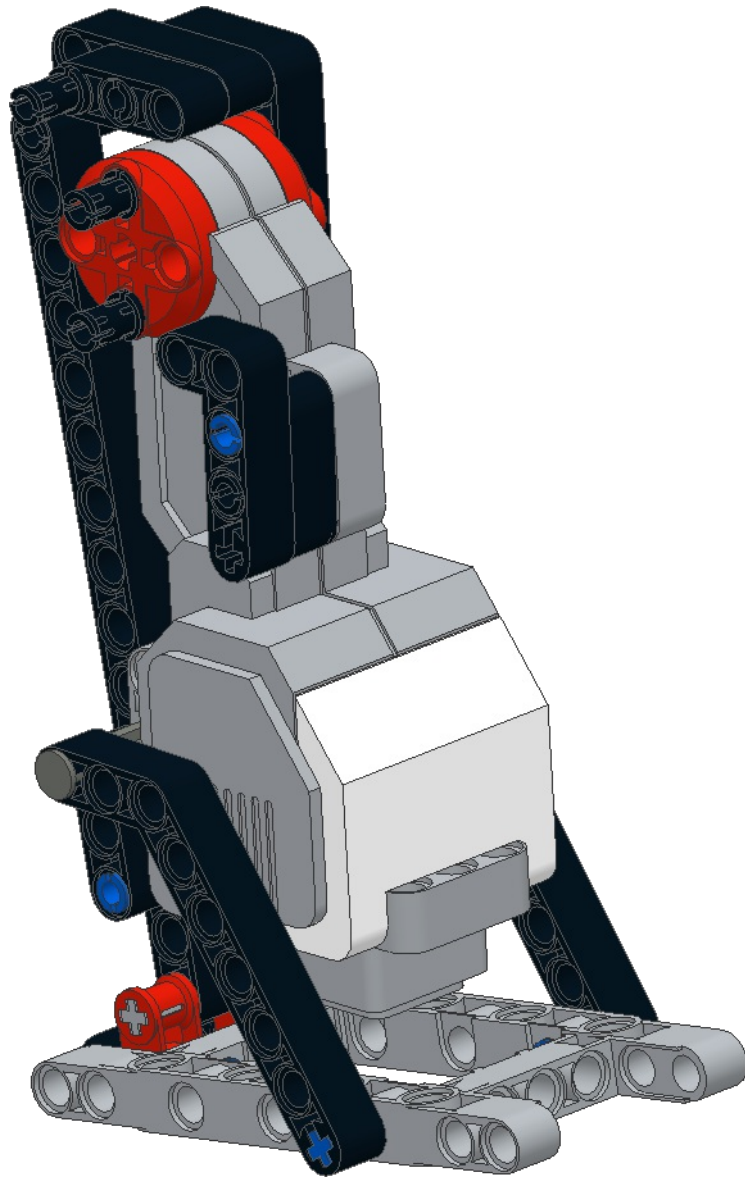
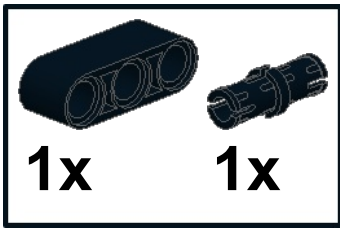

15



1x

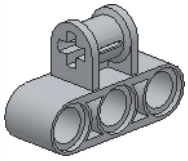

1x

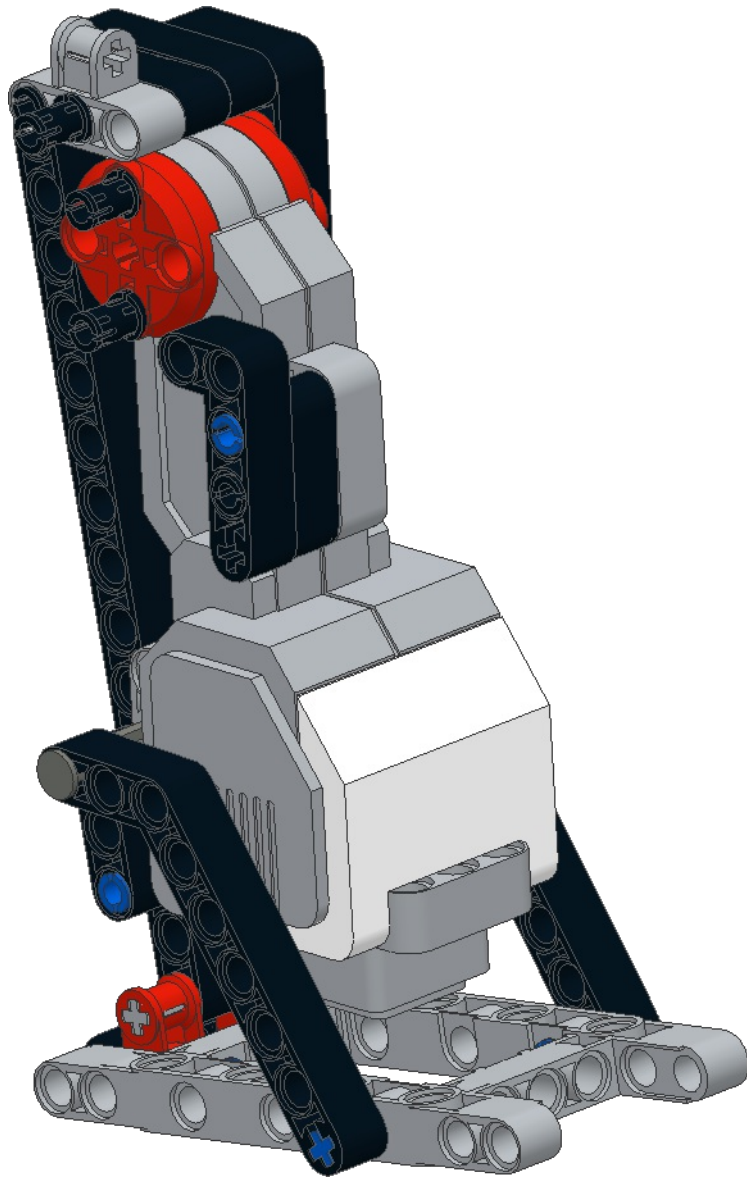

16

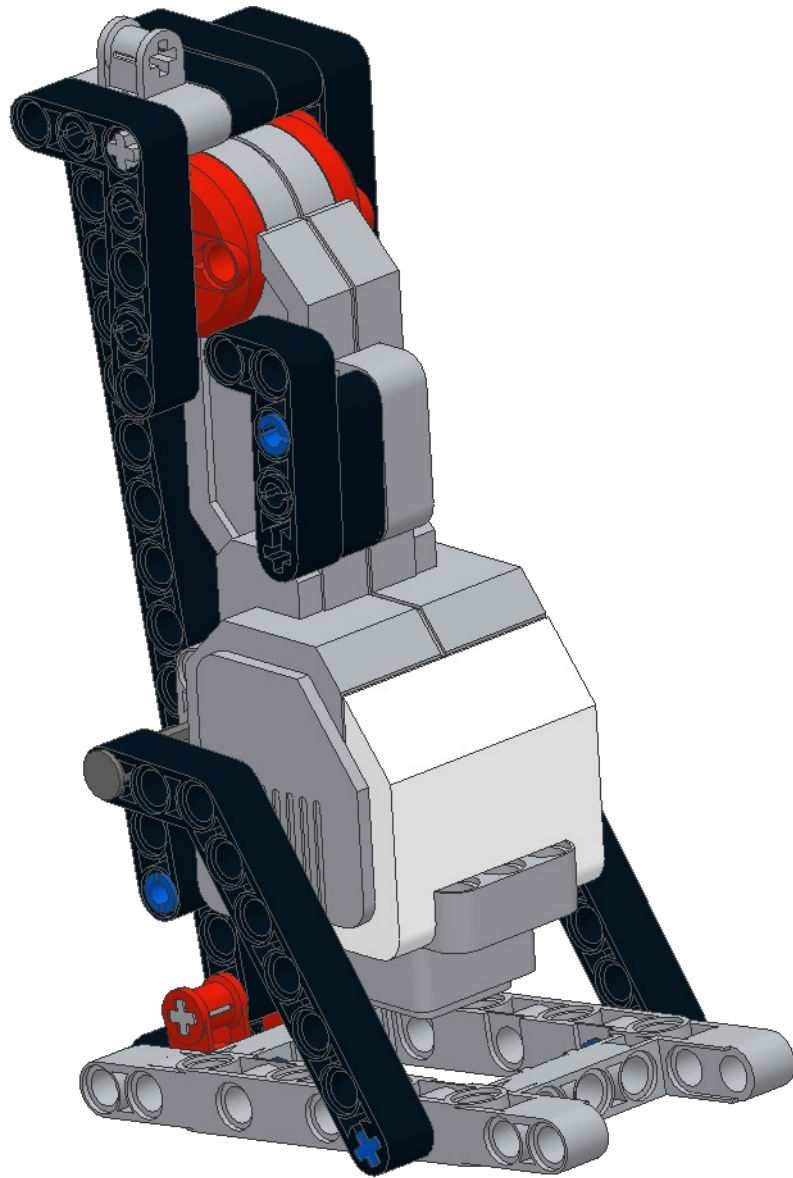
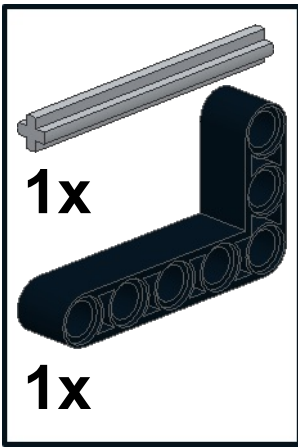

17

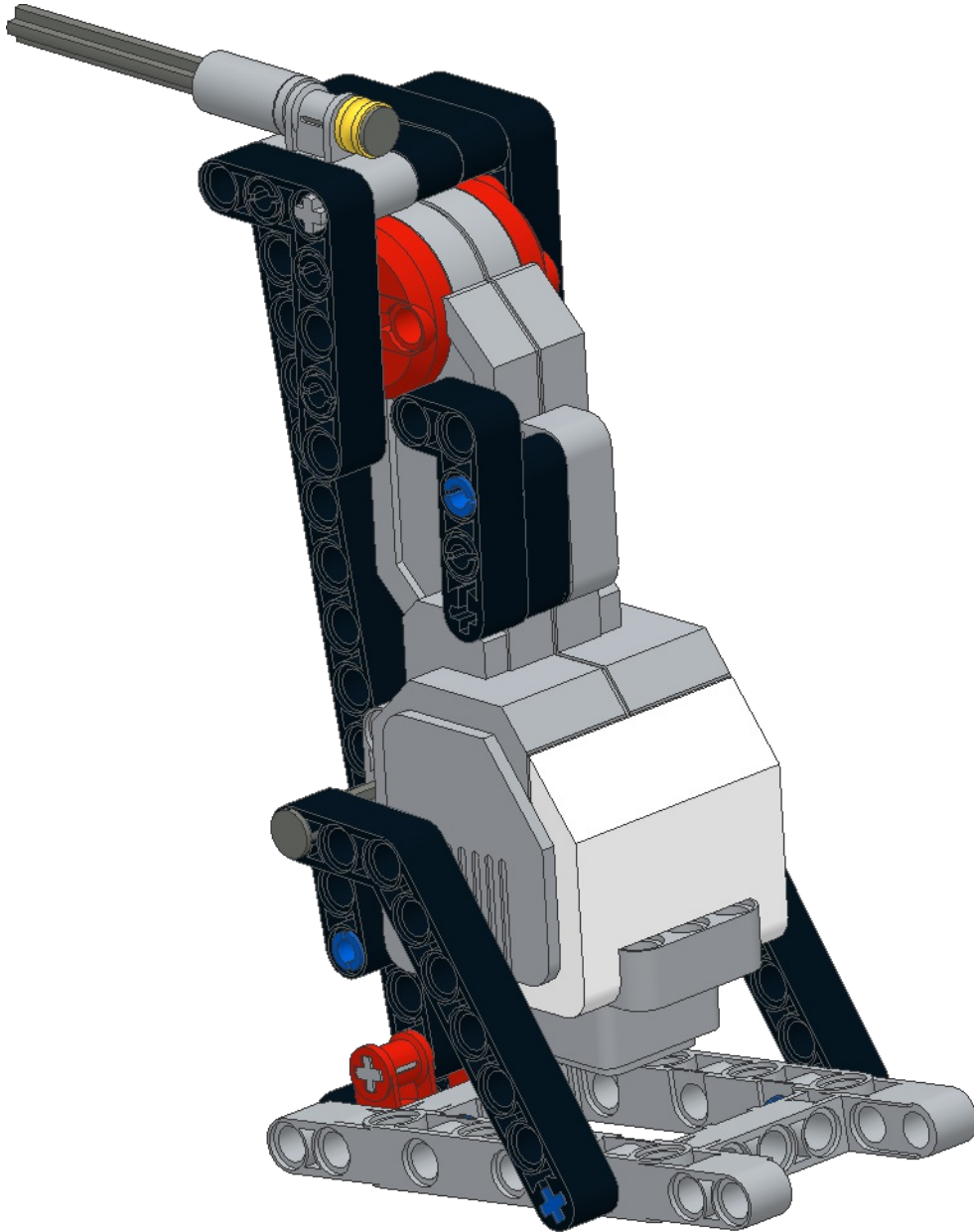
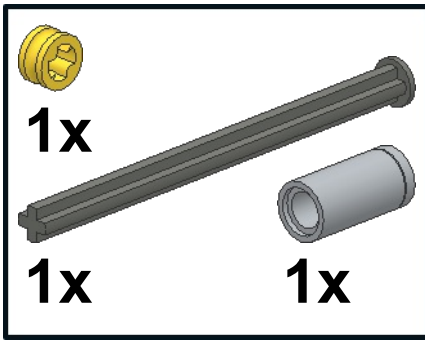

Right Arm



1

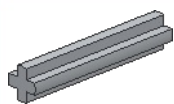

1x



1x

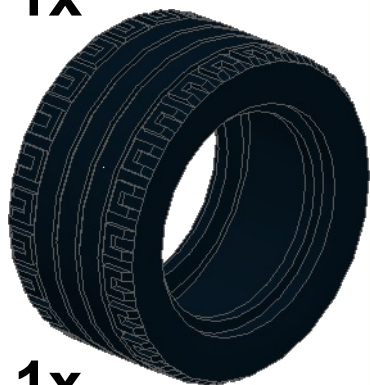

1x



2

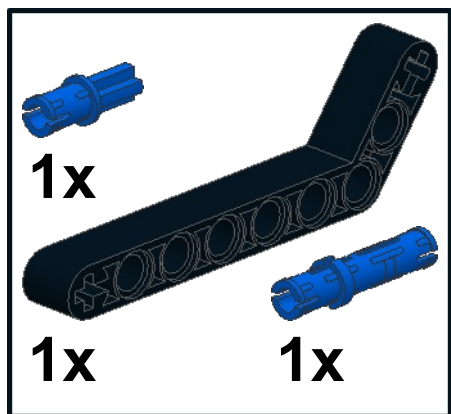

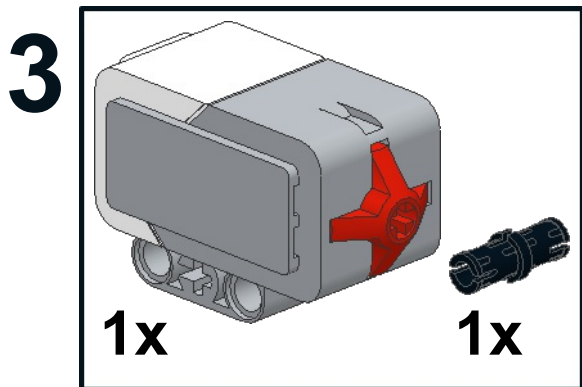

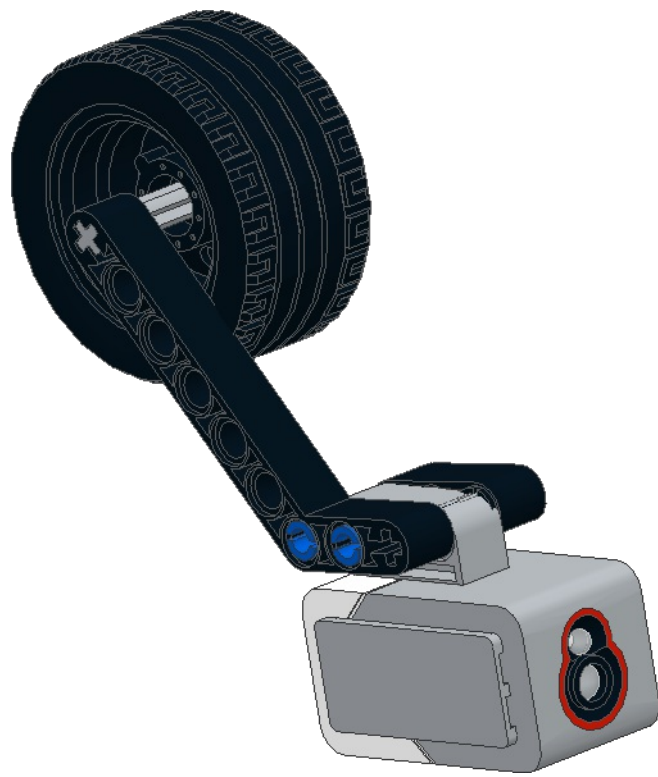
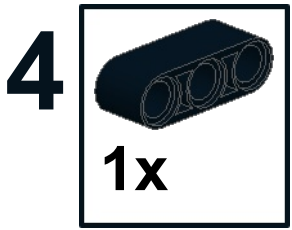

5



1x



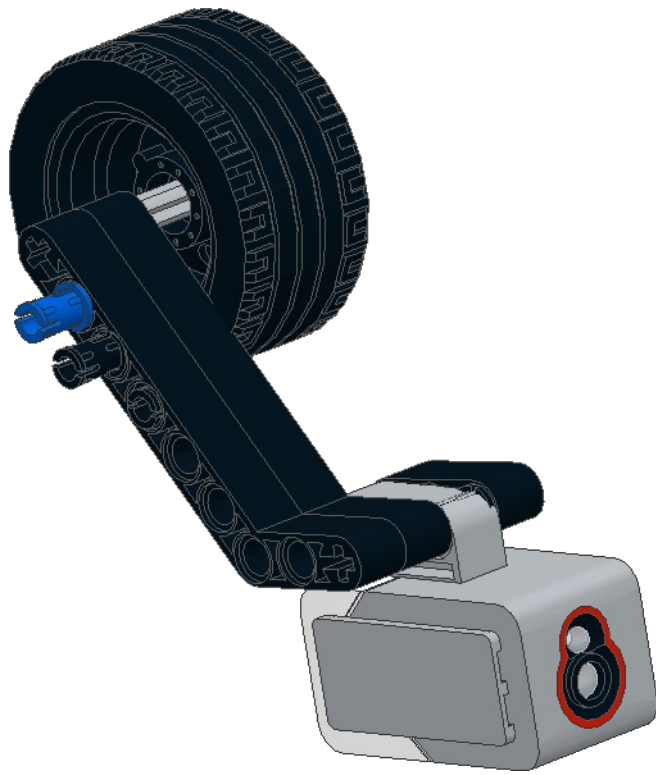
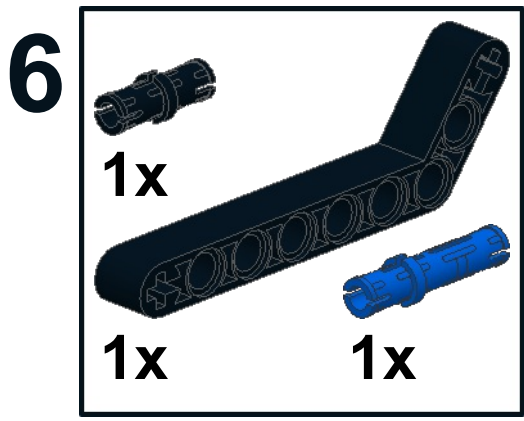

7

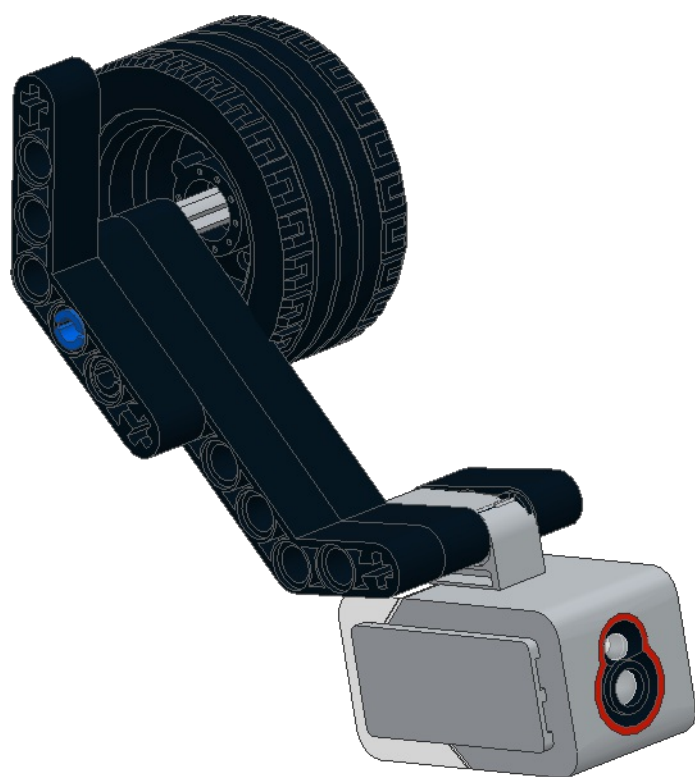
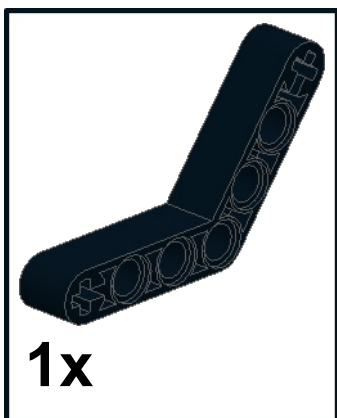

Left Arm



1

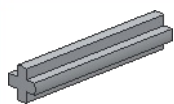

1x



1x



1x



2

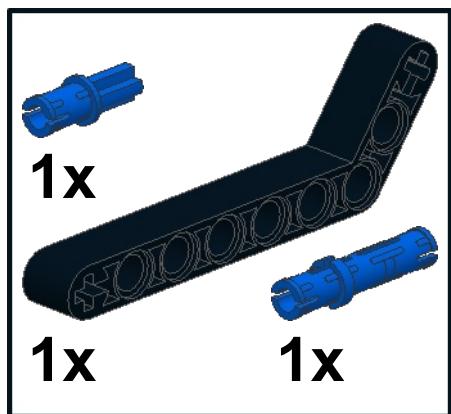

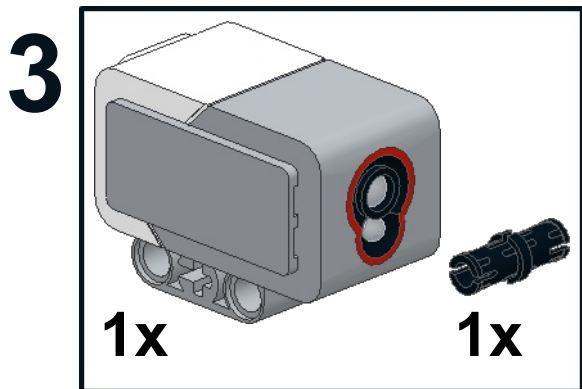

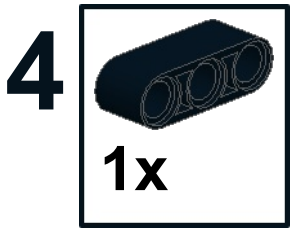

5



1x



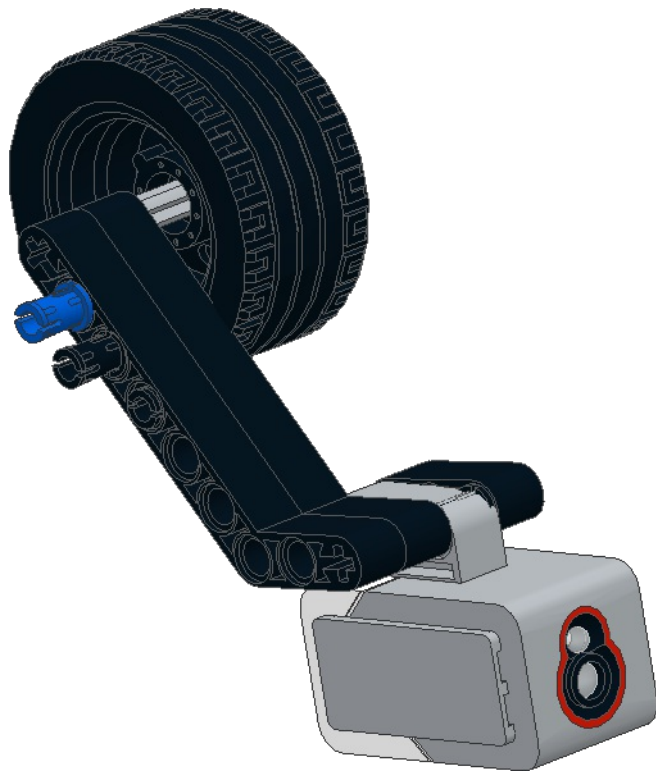
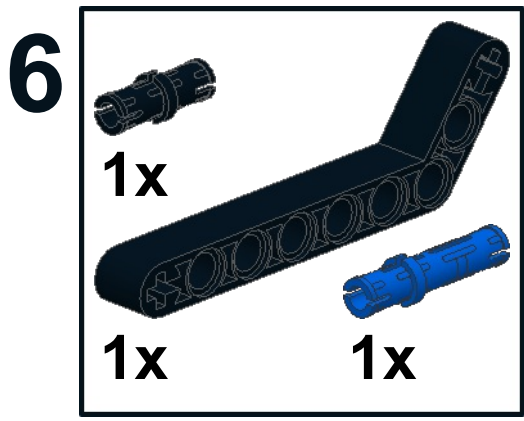

7

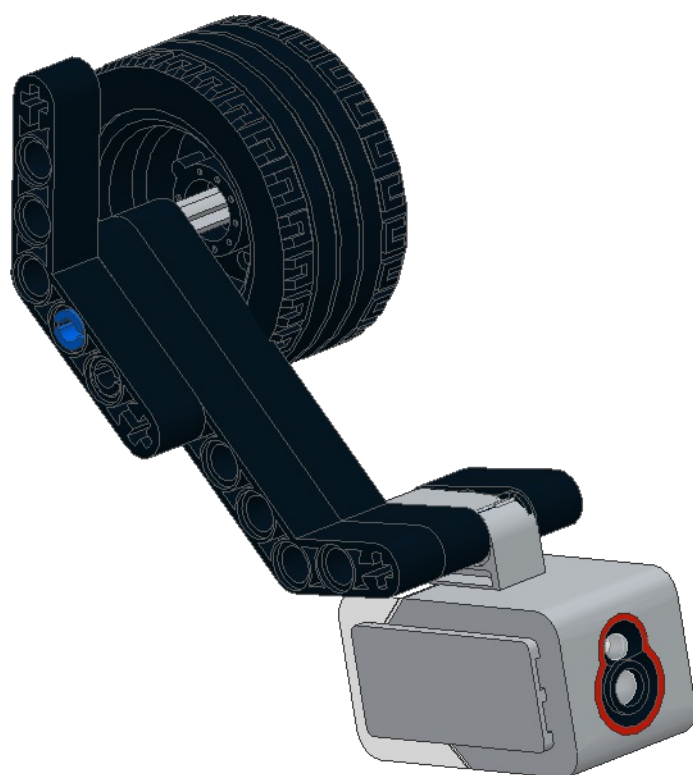
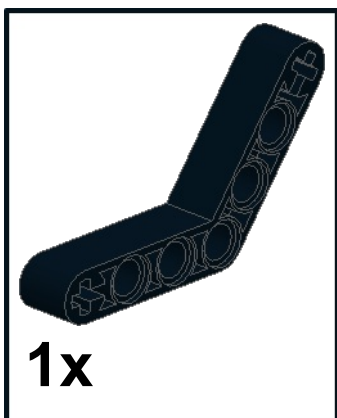

Arm Motor

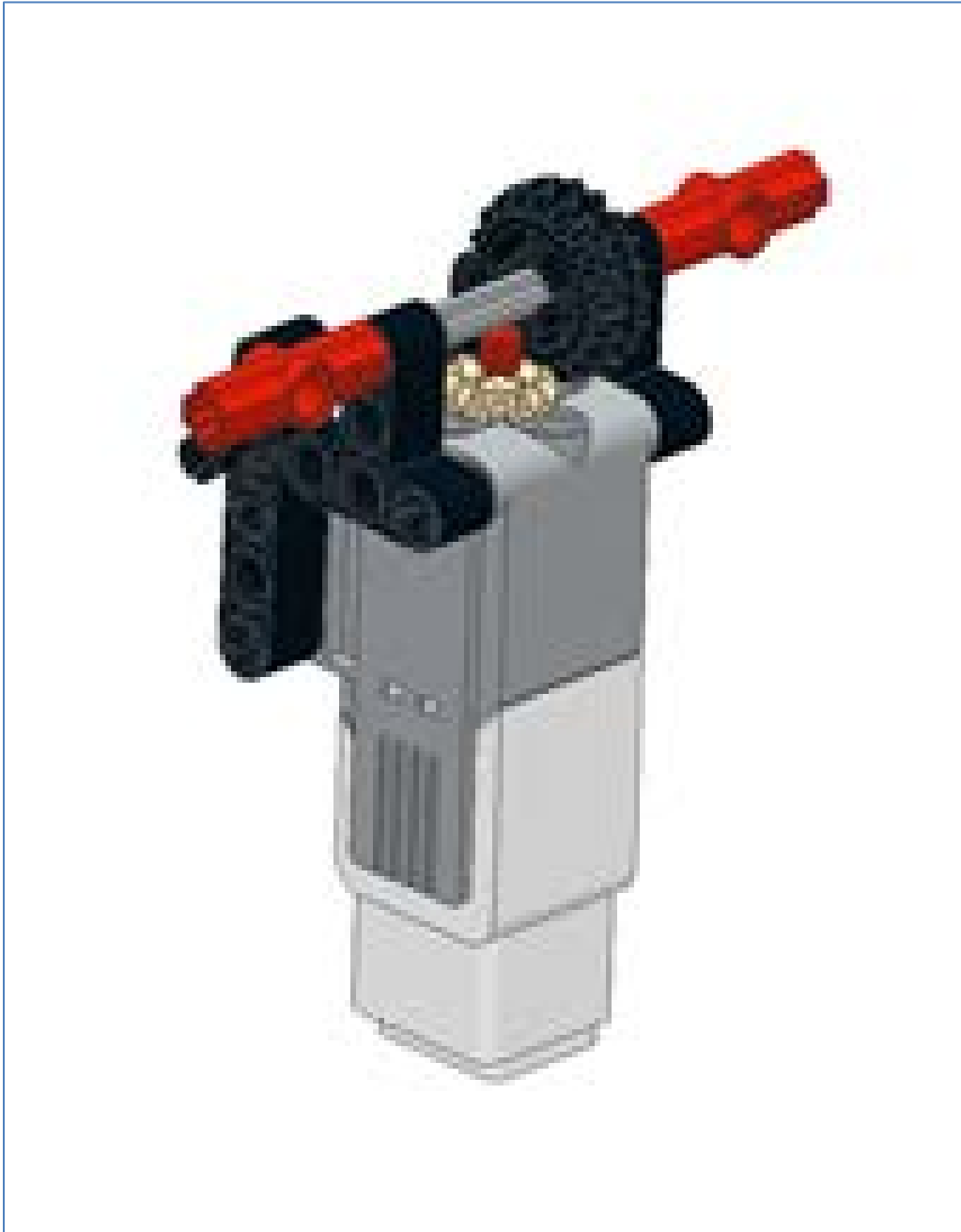

1

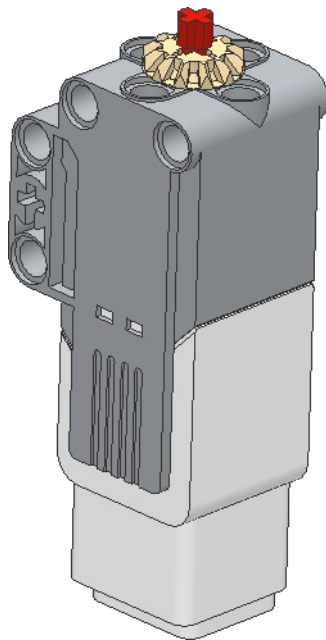
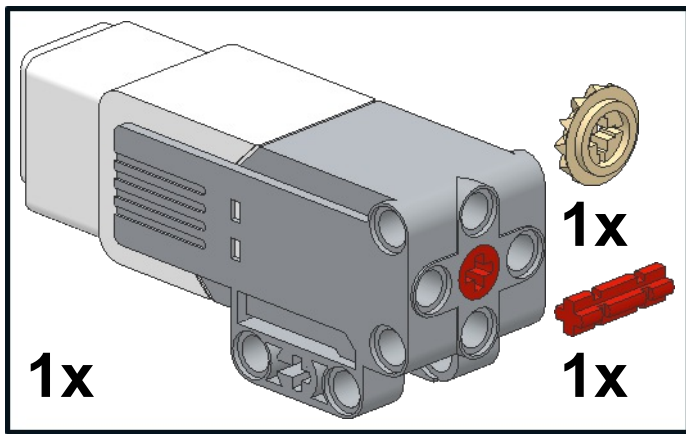

2
4x

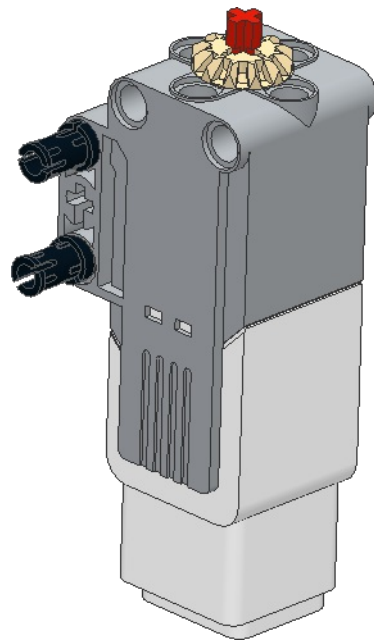

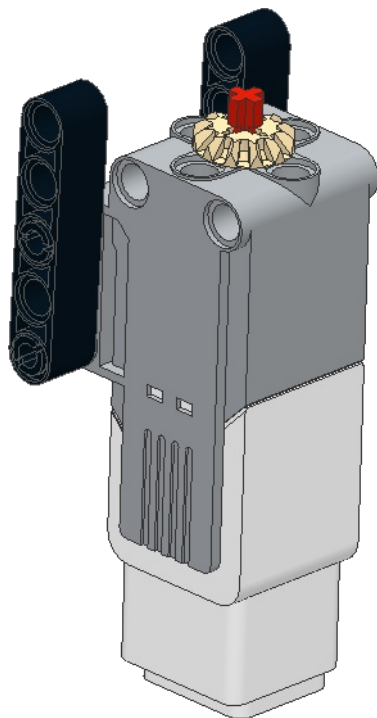
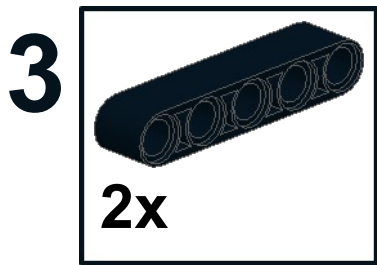

4
4x

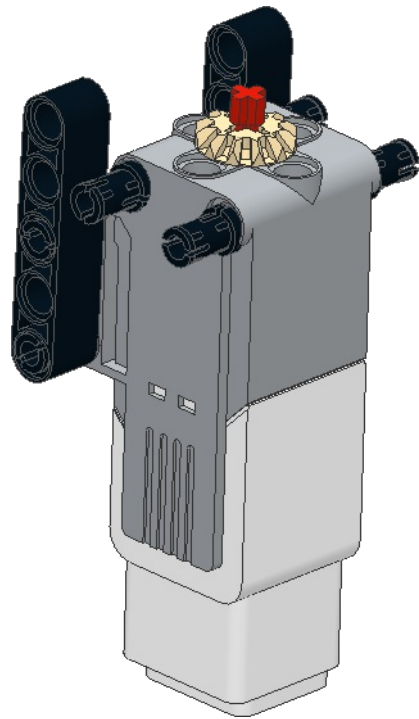

5

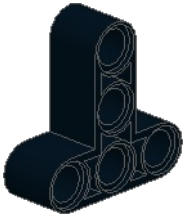

2x

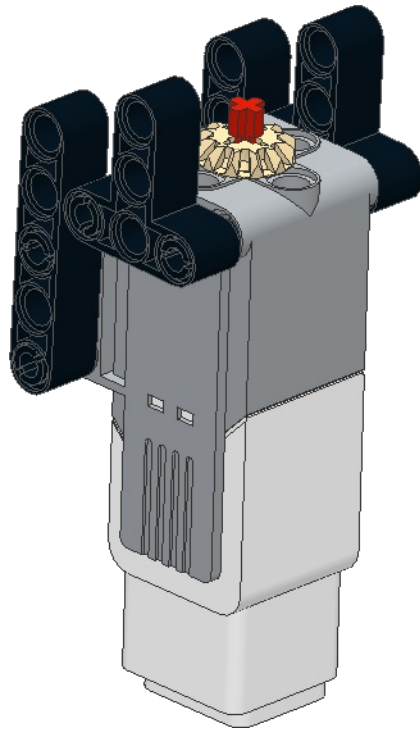

6

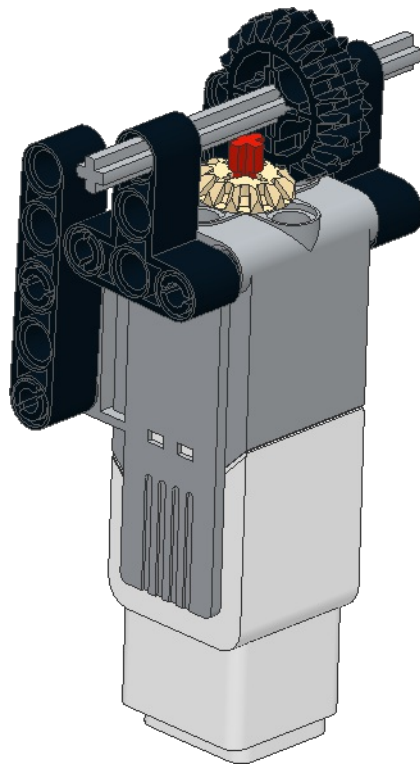
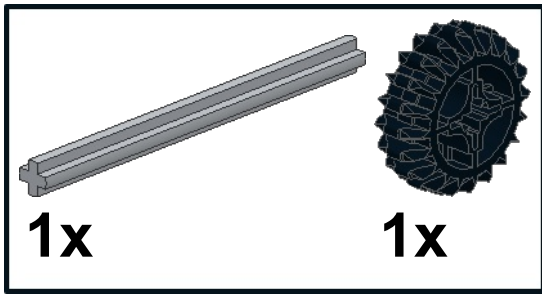

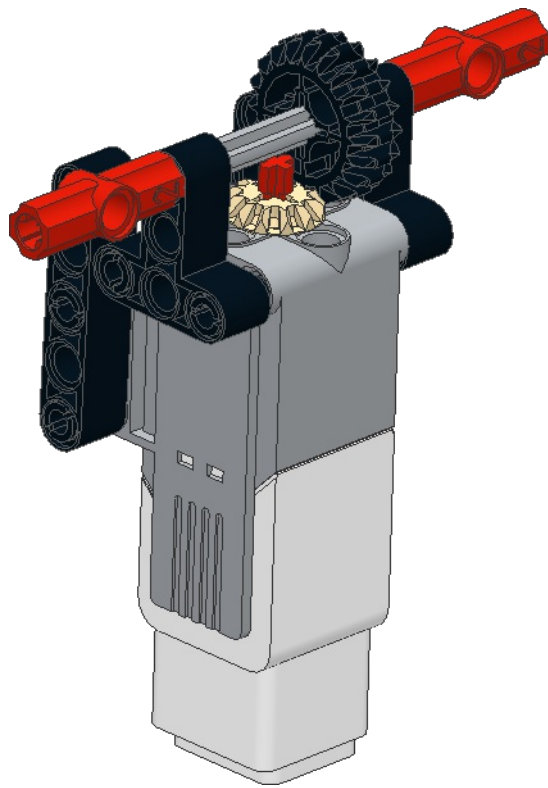
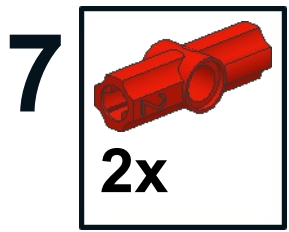

Robot Head

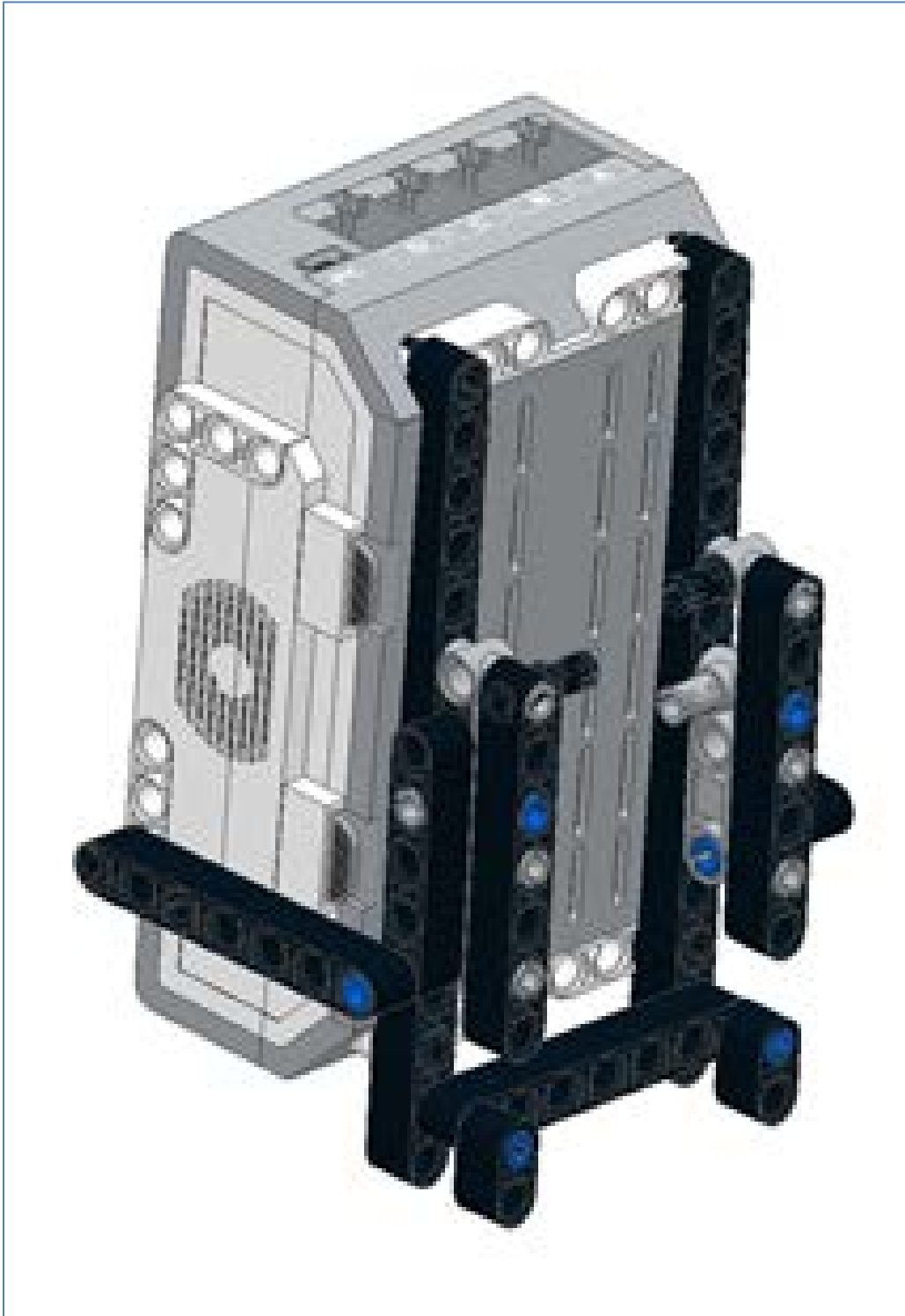

1



4x

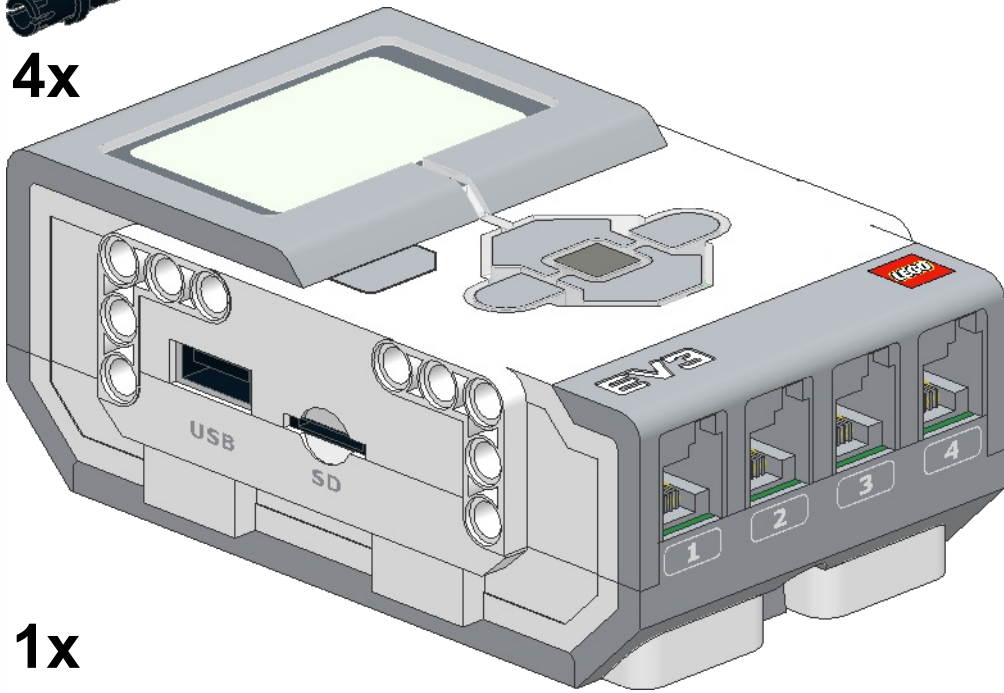

1x

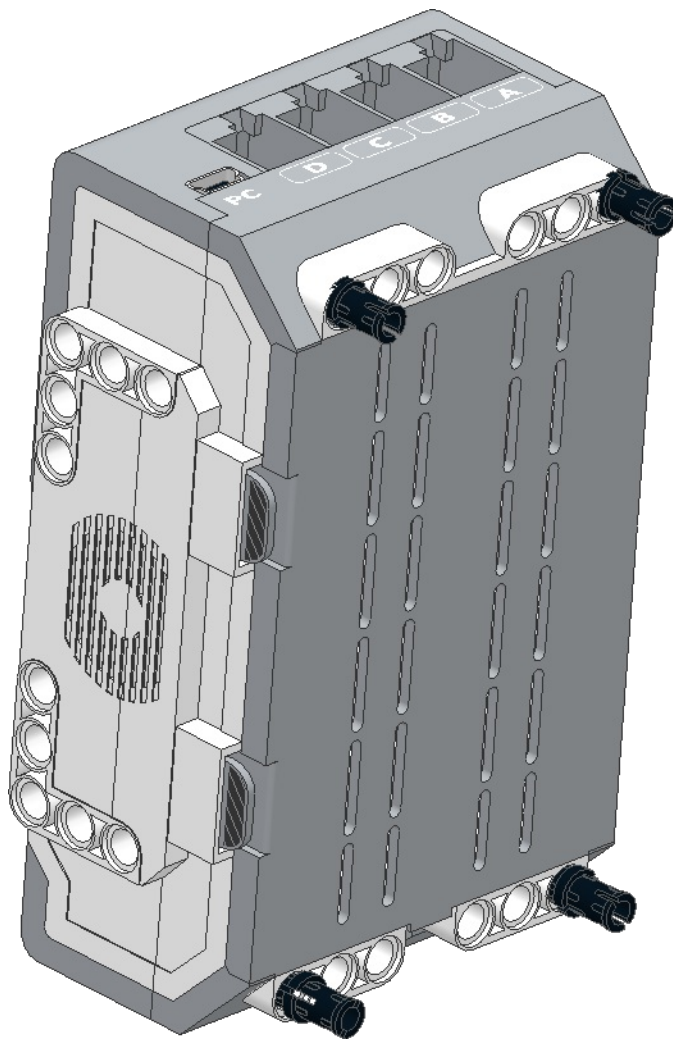

2

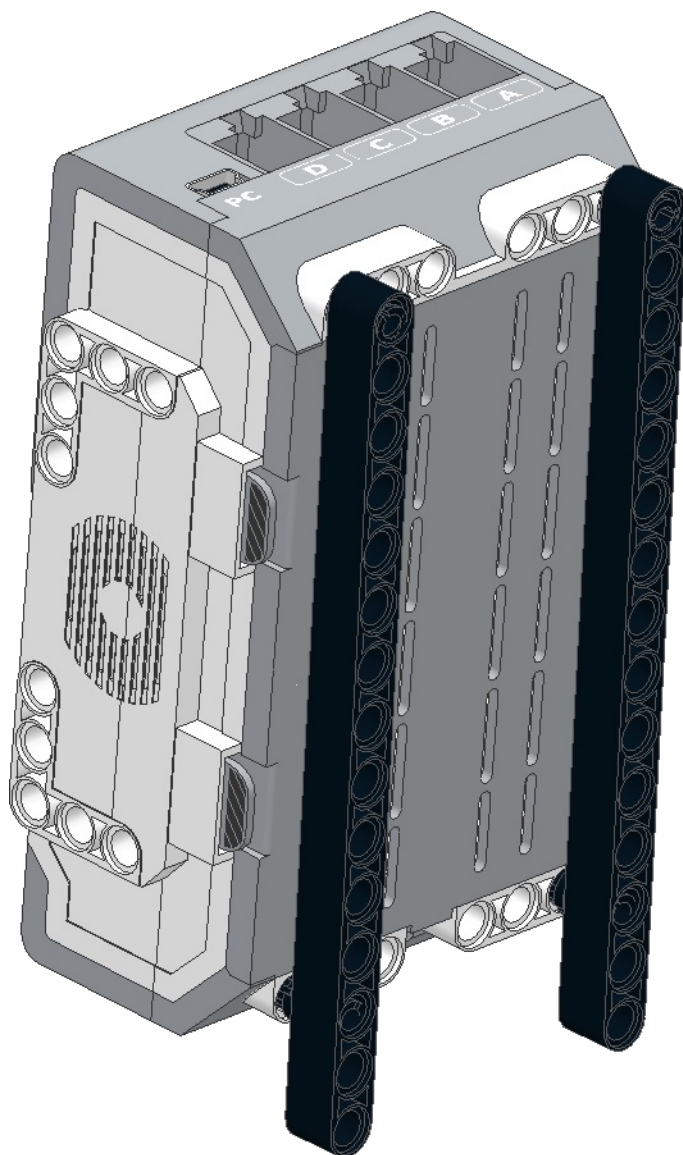
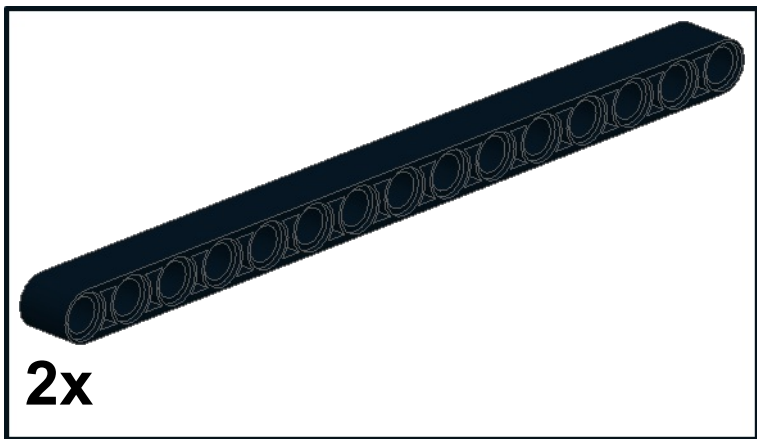

3



2x

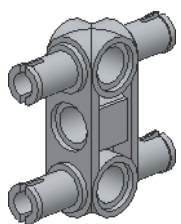

2x

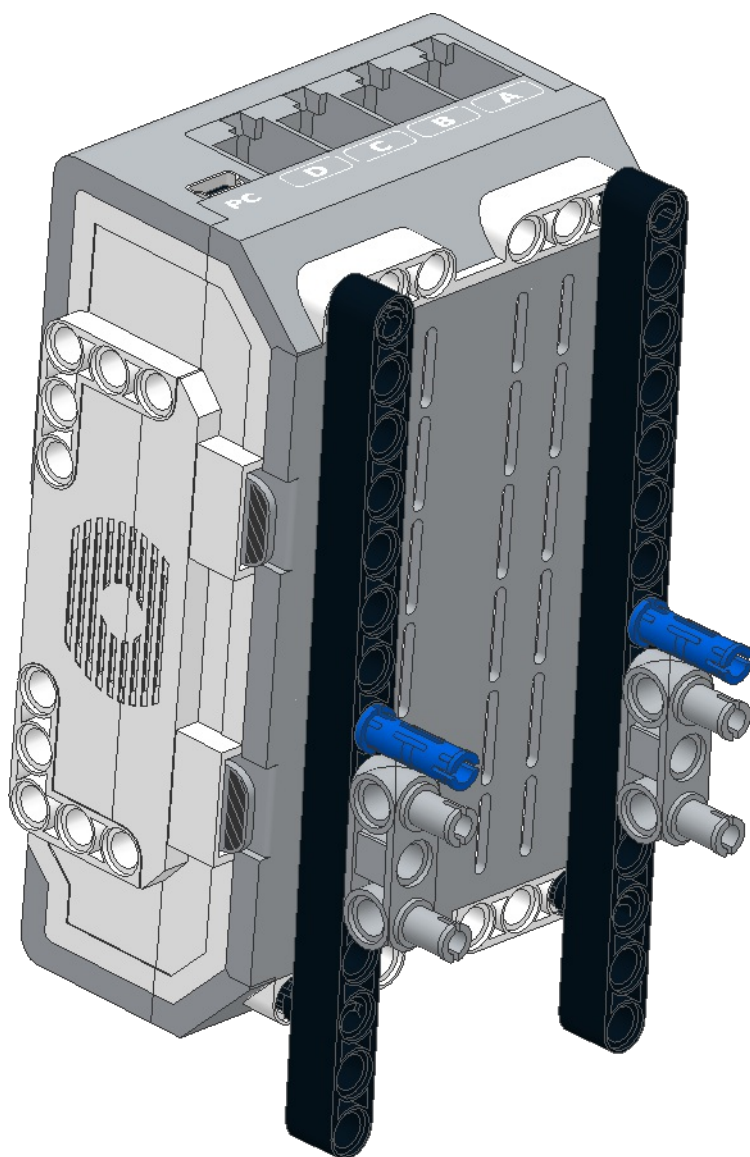

4

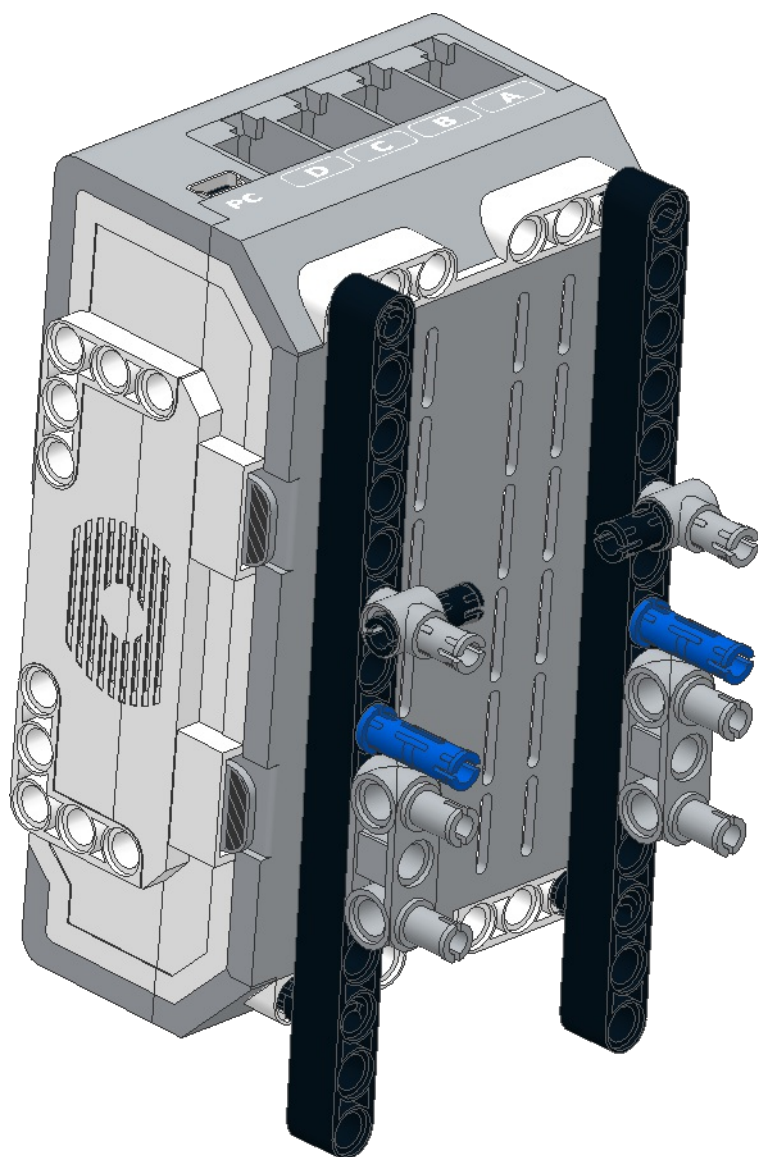
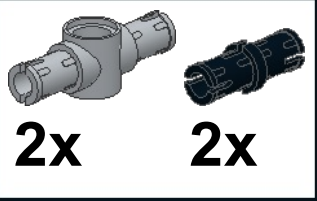

5

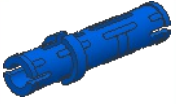

2x

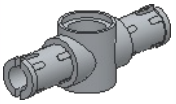

2x

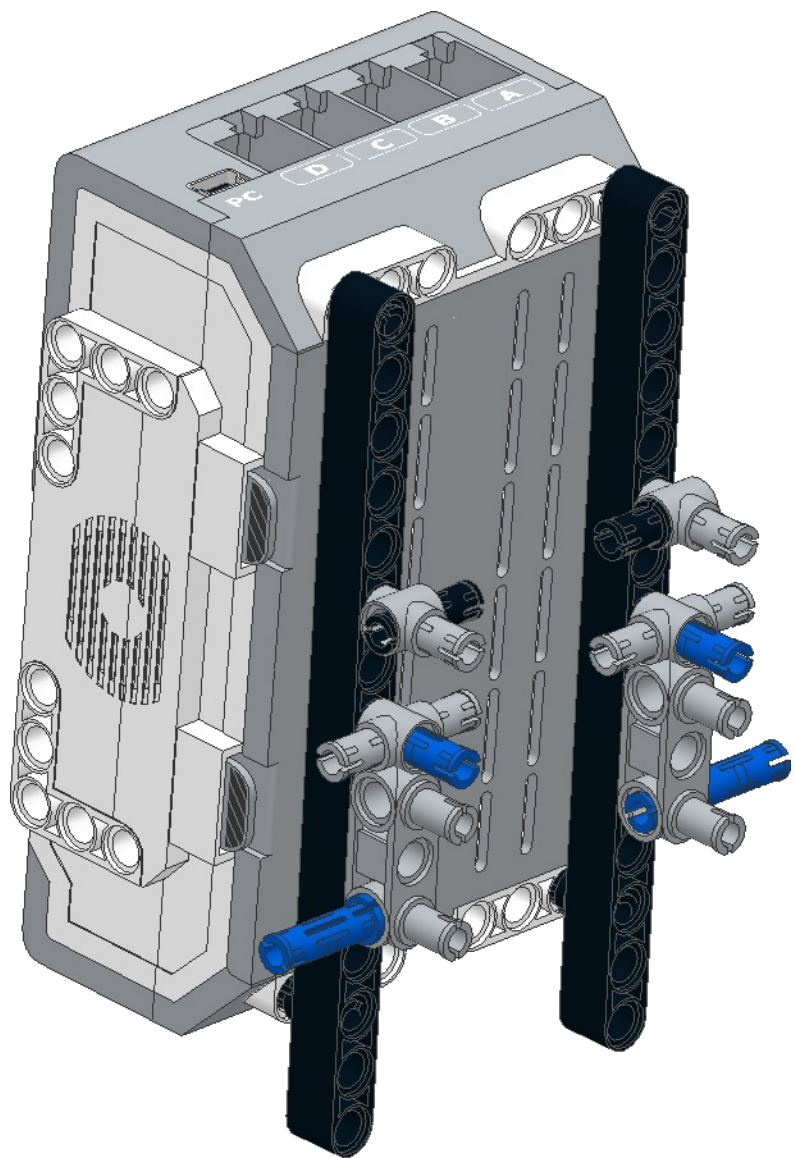

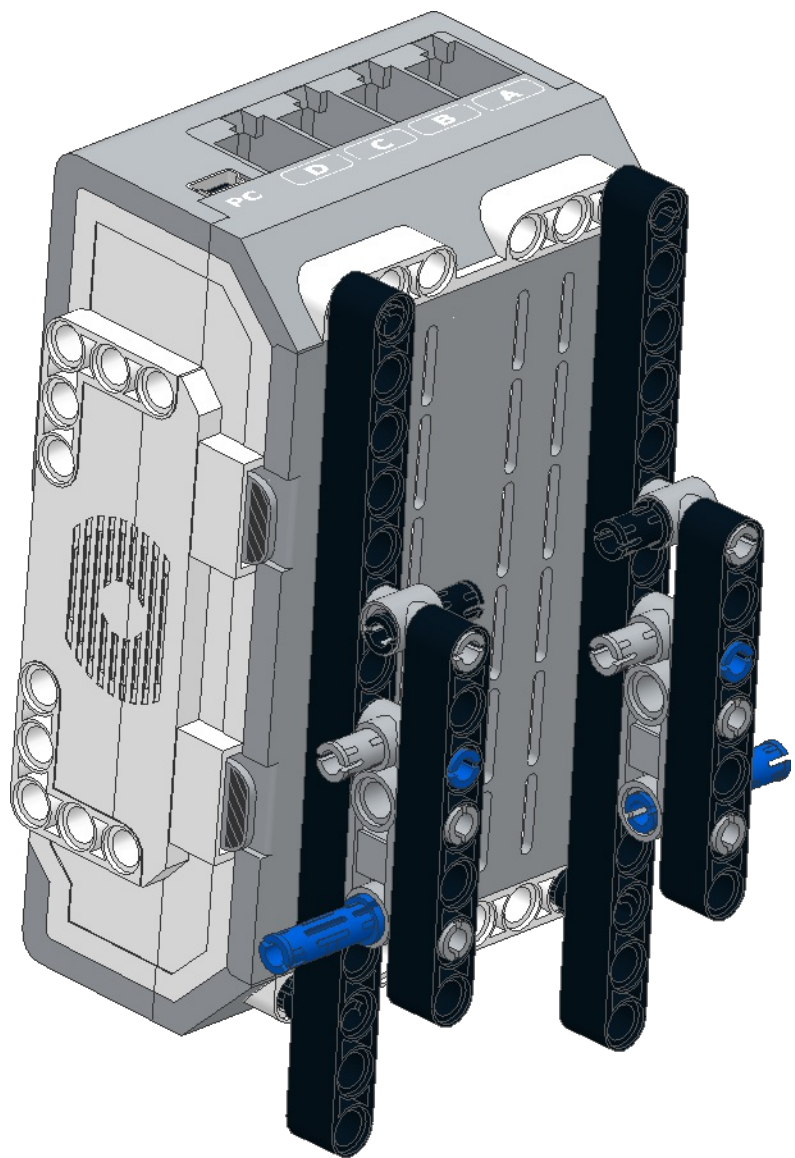
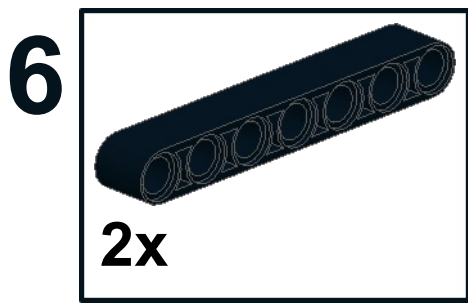

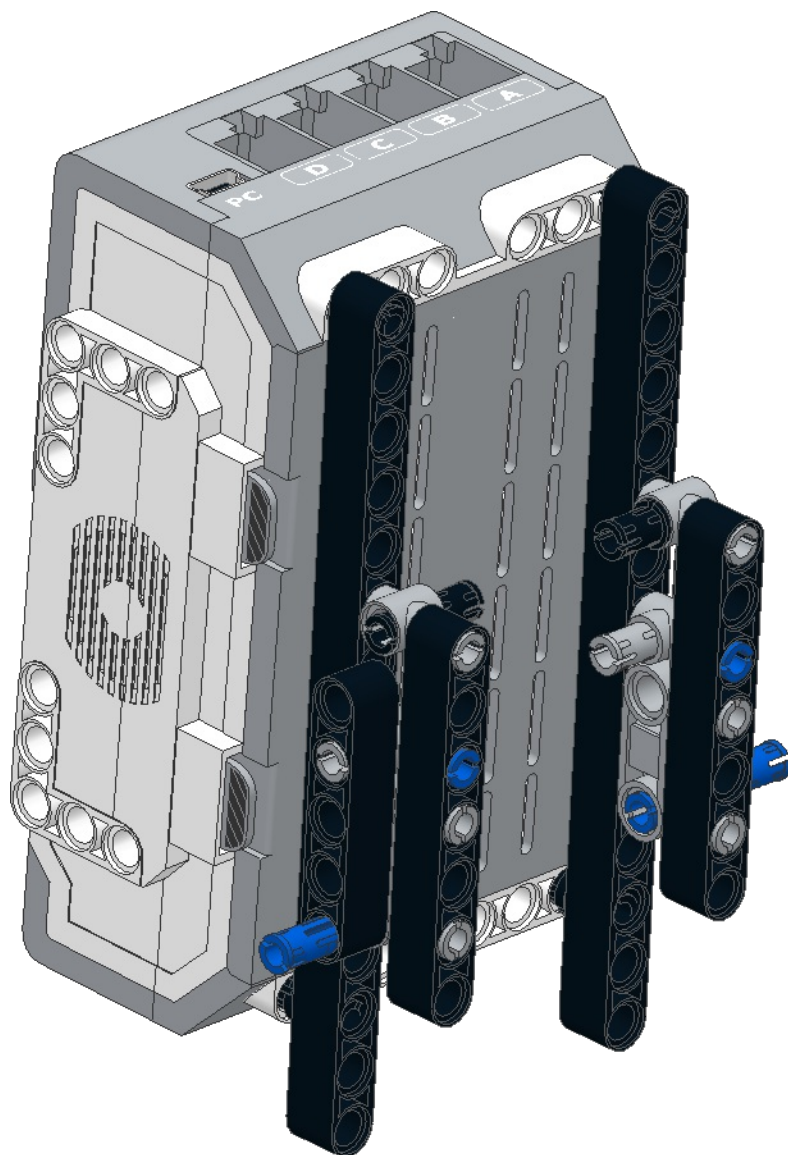
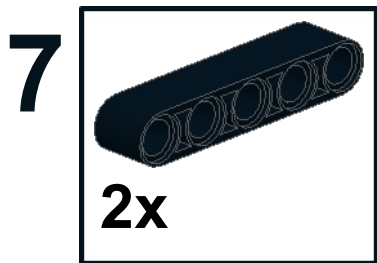

8
2x

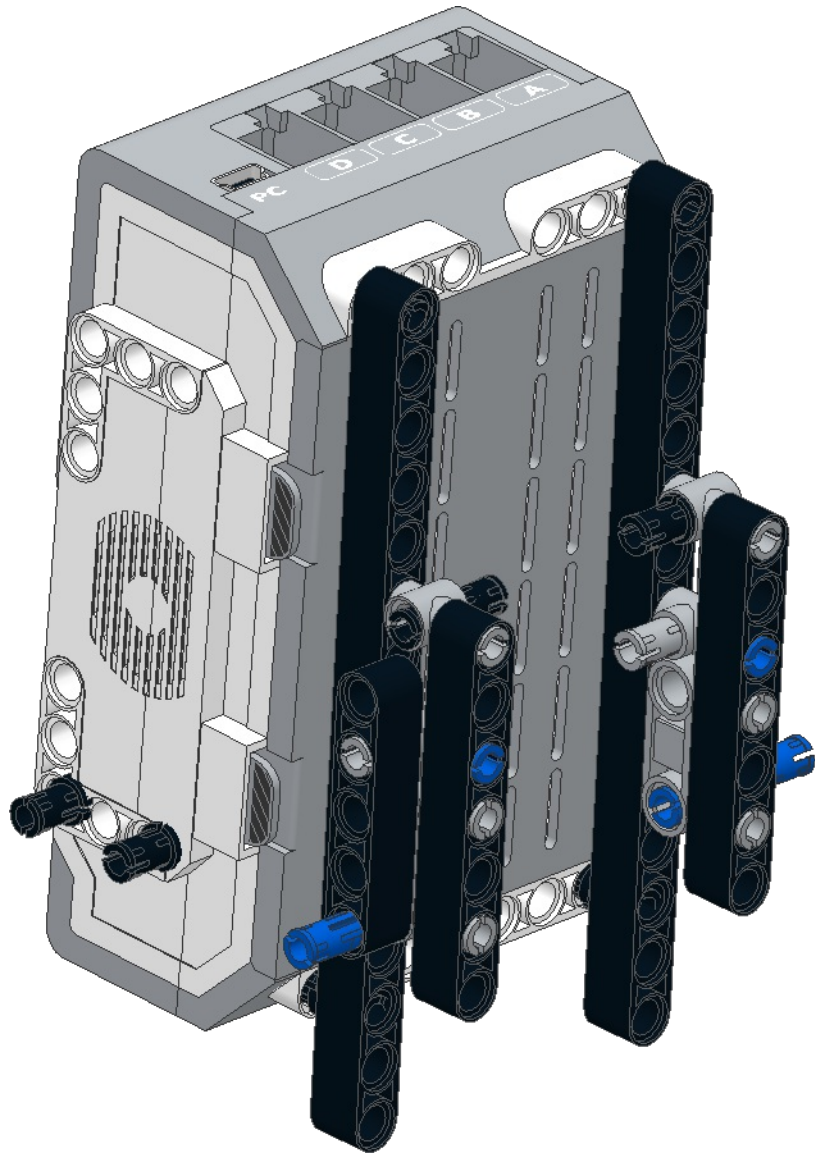

9

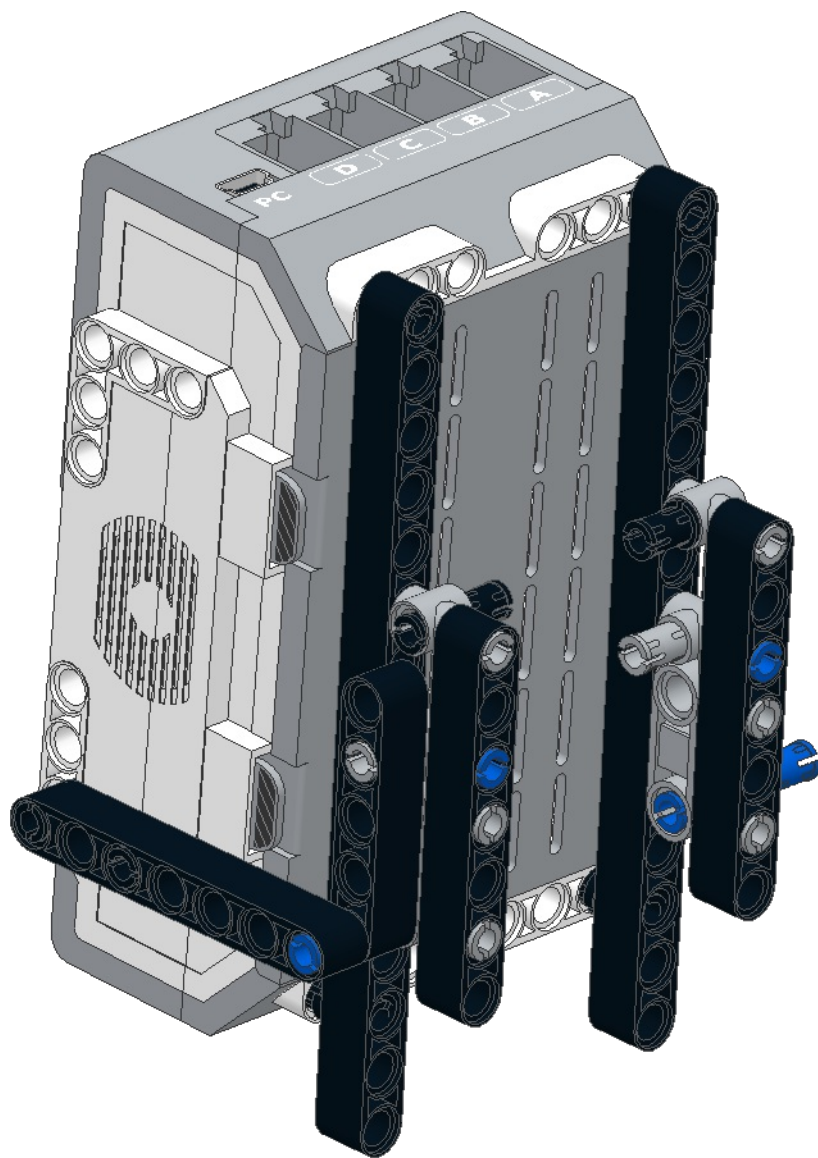
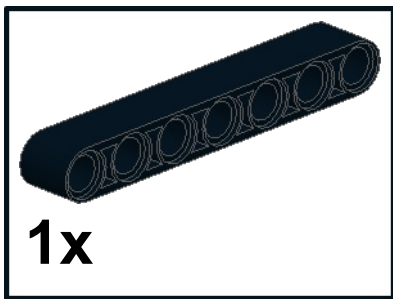

10



2x



11

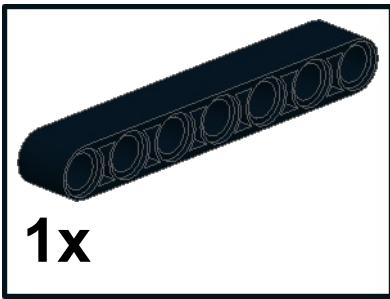

12

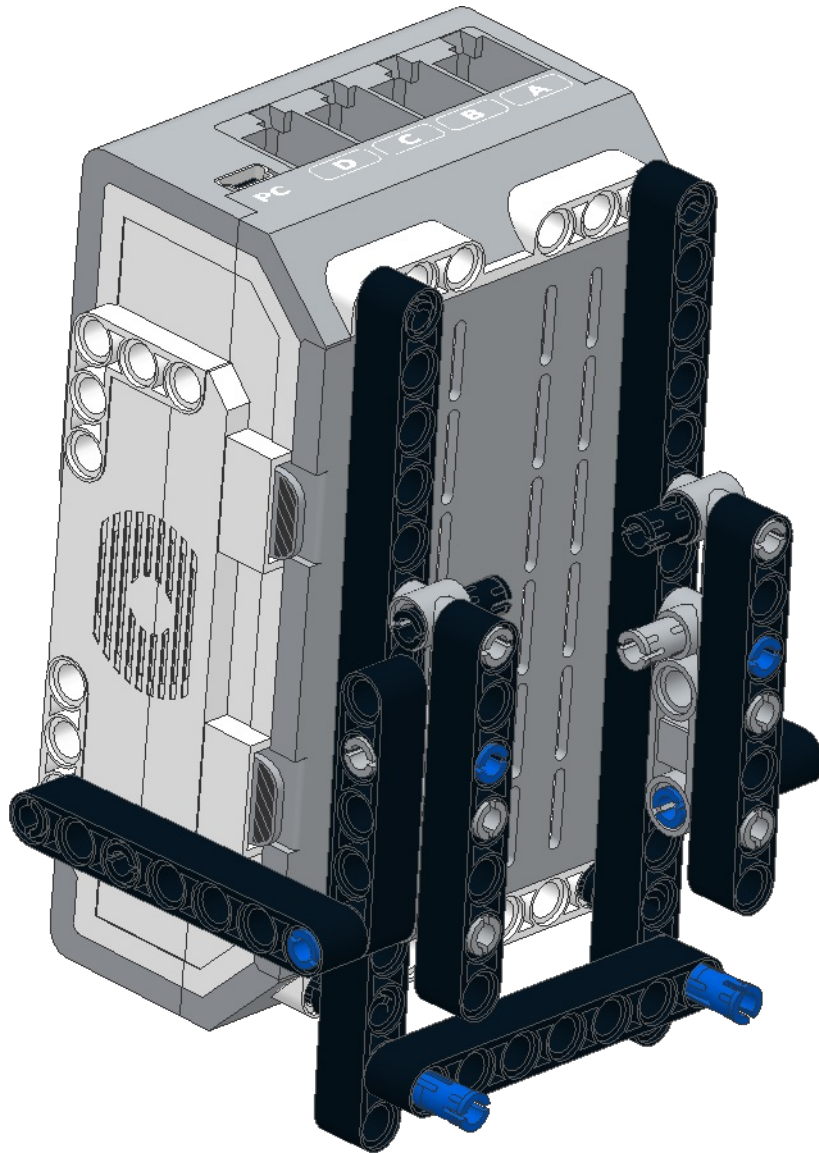
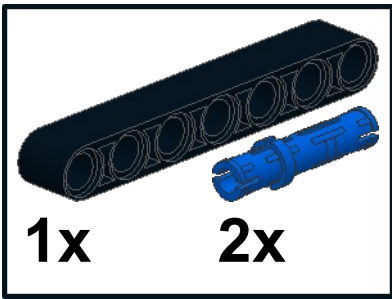

13

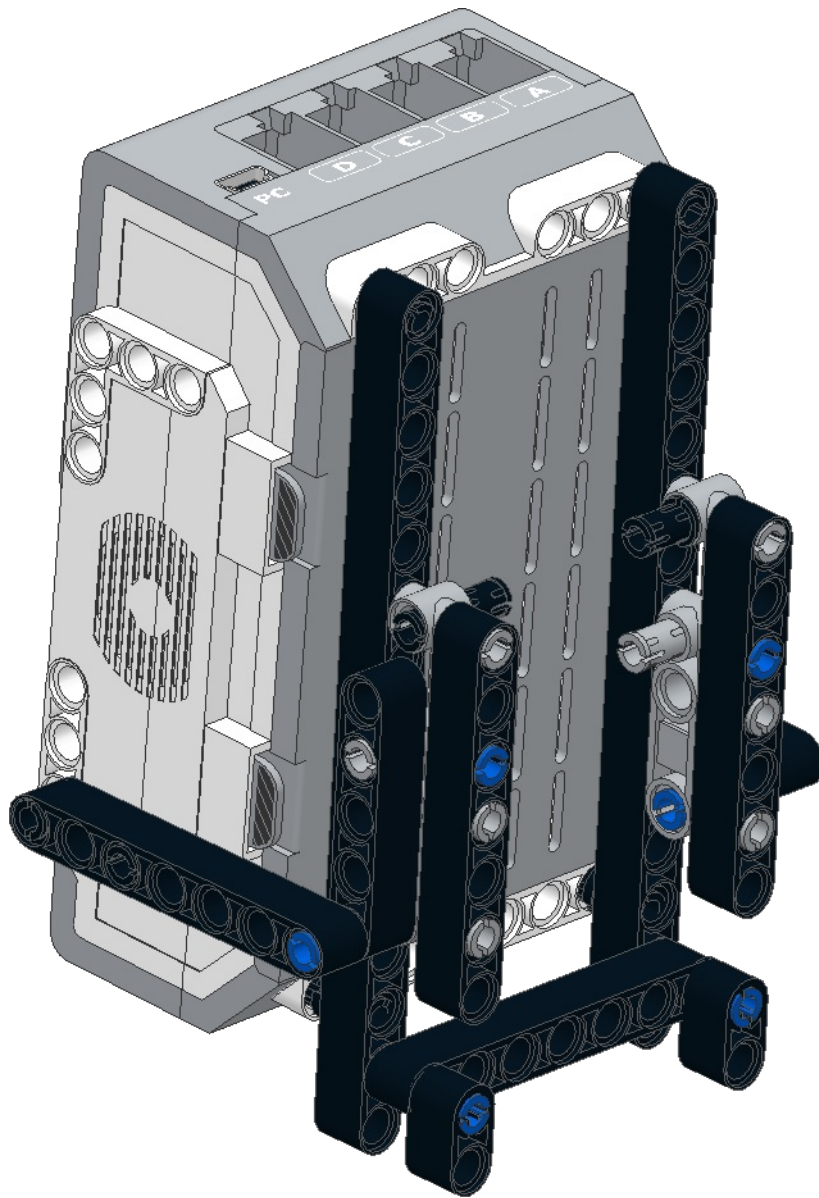

Final Steps

Slide leg pins through holes to connect to the frame.

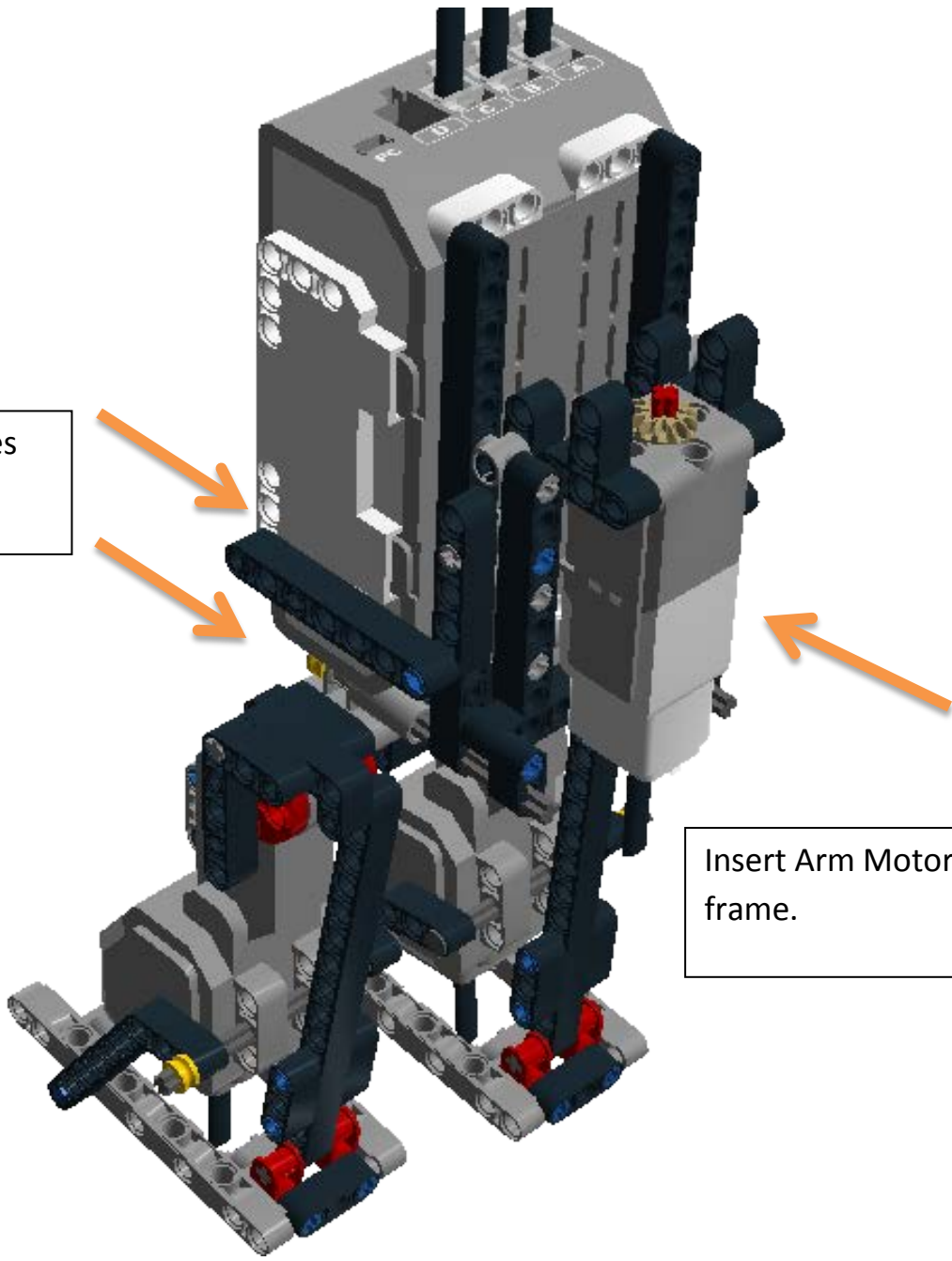

Insert Arm Motor onto frame.

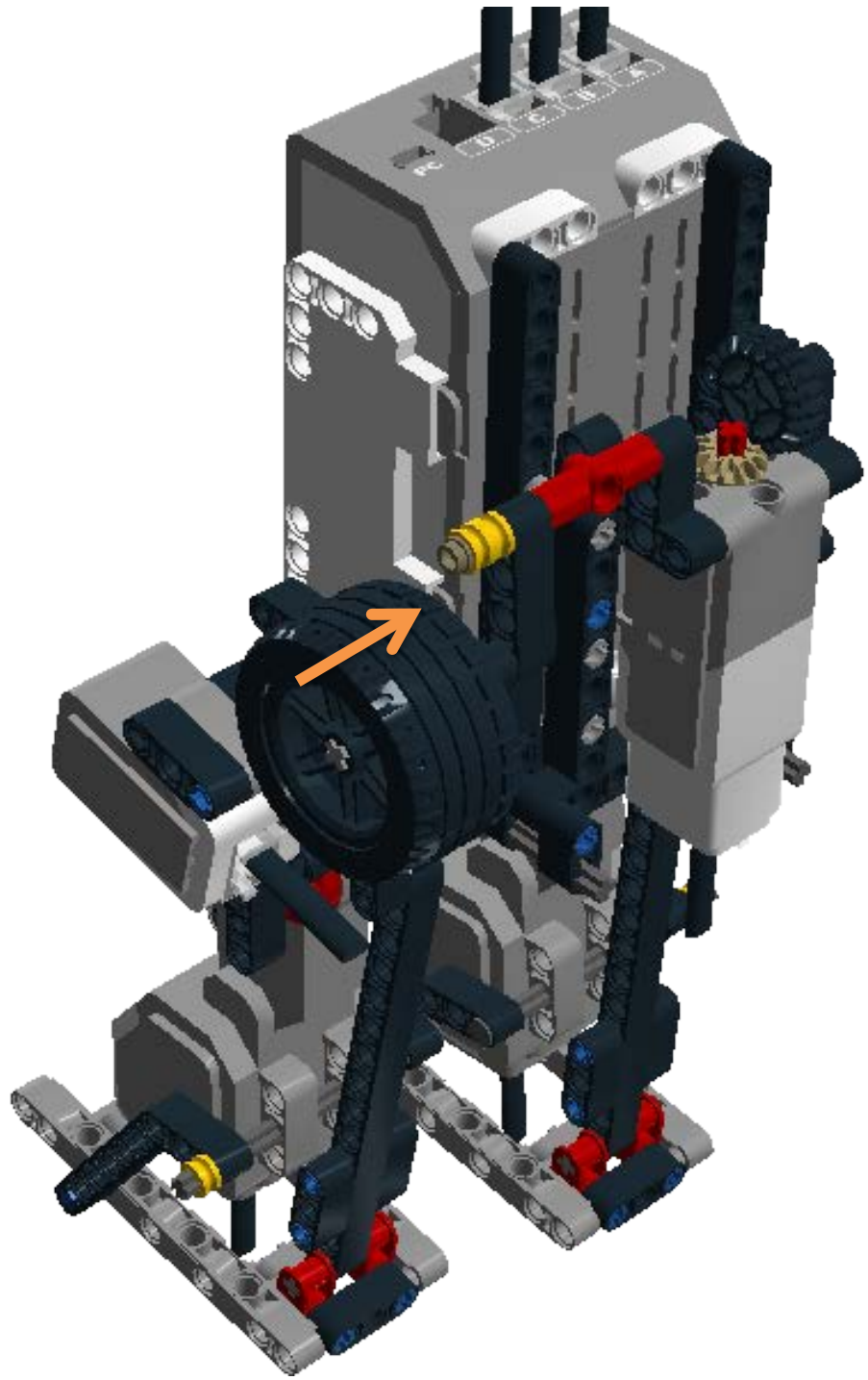

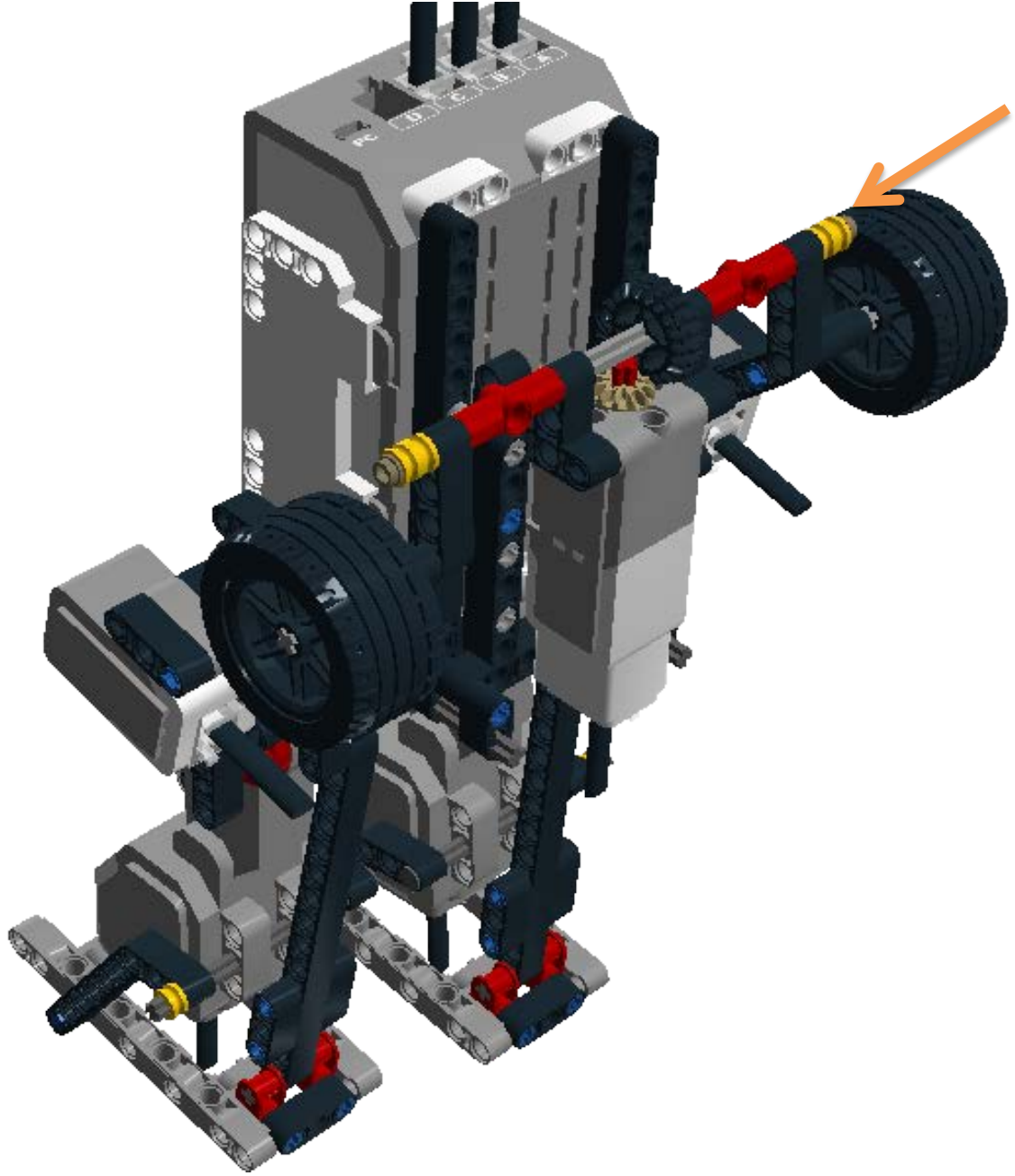

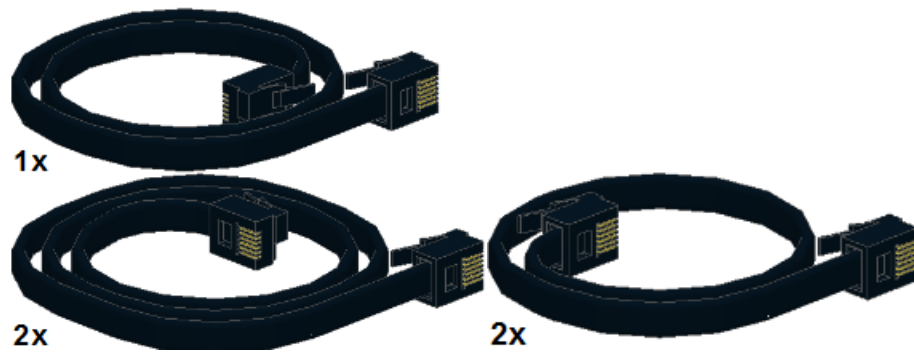

Connect Wires:

25cm Wire from EV3 Color Sensor --> EV3 Brick Port 2

25cm Wire from EV3 Touch Sensor → EV3 Brick Port 1

35cm Wire from Medium Motor → EV3 Brick Port A (Route behind medium motor)

50cm Wire from Left Leg large motor → EV3 Brick Port C

50cm Wire from Right Leg large motor → EV3 Brick Port B

(Route 50cm Wires behind 8cm leg pins and behind medium motor)

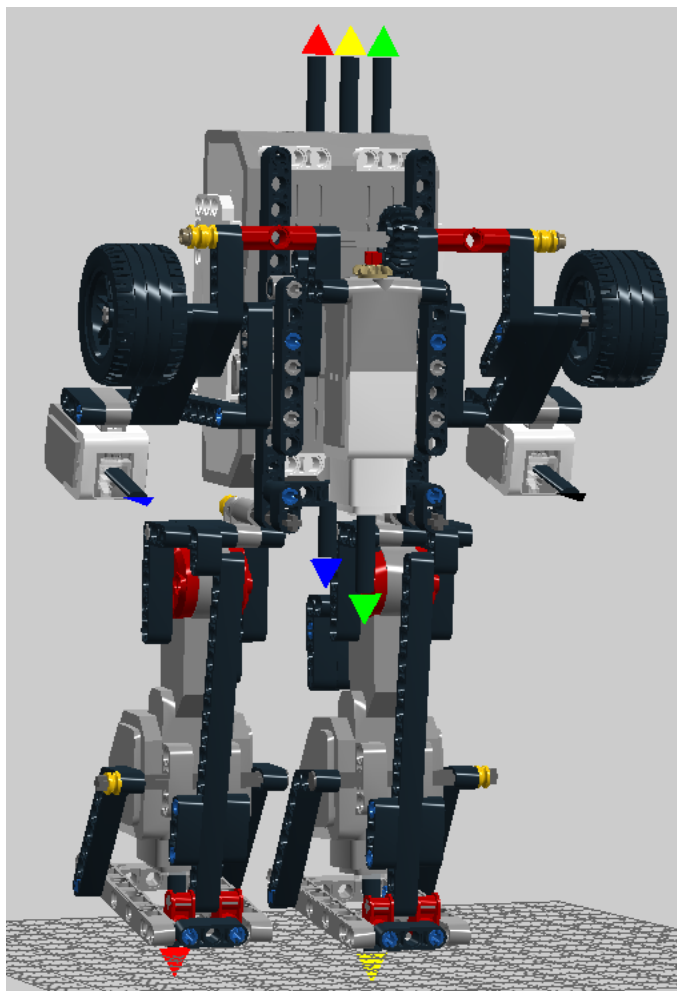



1x



1x



2x



4x



4x



2x



2x



2x



1x

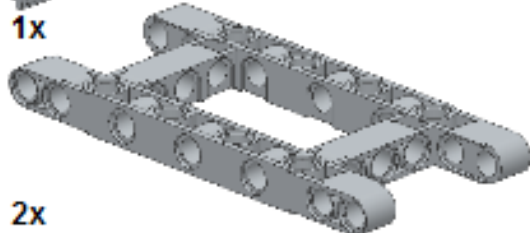

2x



4x



2x

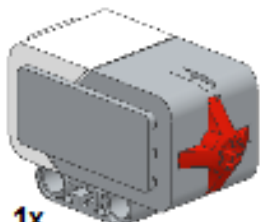

1x

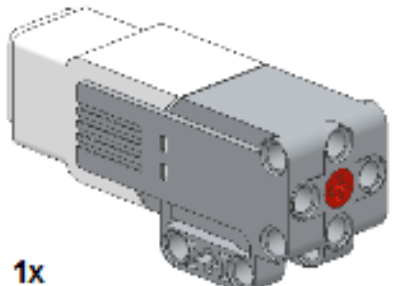

1x

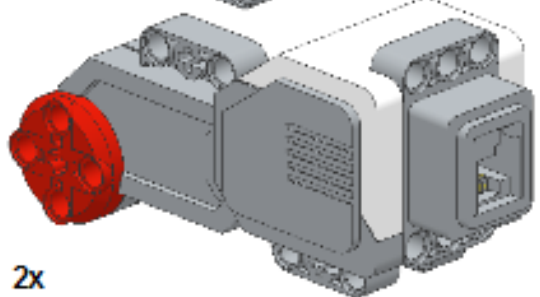

2x

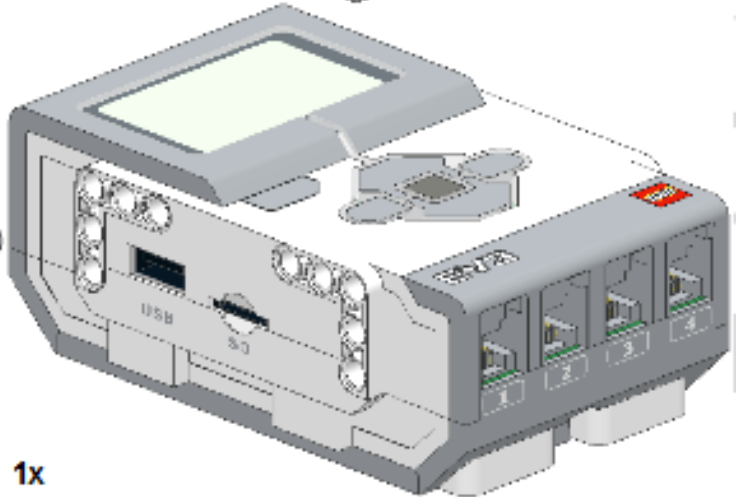

1x

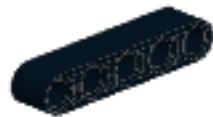

4x

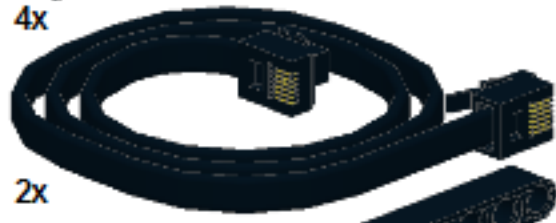

2x



2x

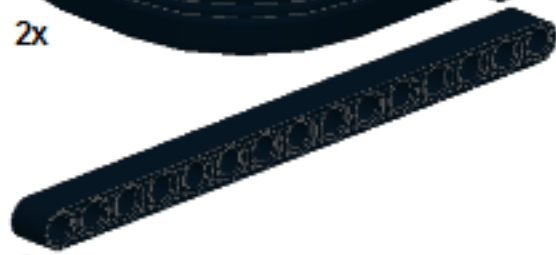

4x



2x



6x



5x



20x



46x



4x



2x

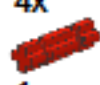

1x



2x



1x



2x



12x



8x



8x



2x

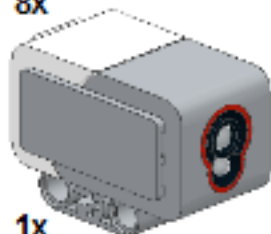

1x



2x



4x



1x

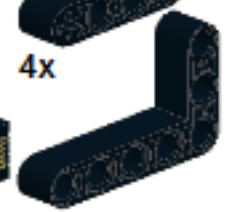

4x